

AGENDA
ANC 6A Transportation & Public Space Committee Meeting
Virtual Meeting via Zoom
Call-in Number: 1 301 715 8592
Webinar ID (access code): 967 4031 8374
For those attending via Zoom: <https://zoom.us/j/96740318374>
One tap mobile: +13017158592,, 96740318374#
Public Meeting – All are welcome
May 17, 2021 at 7:00 pm

- I. Call meeting to order.
- II. Introductions & Announcements (5 minutes)
- III. Old Business
 - A. Update on proposal to site a public bathroom on 17th Street and Benning Road NE under the Public Restroom Facilities and Promotion Act.
 - B. Discussion of DDOT Notice of Intent to install on-way protected bikeways on the 800 and 900 blocks of West Virginia Avenue NE (NOI # 21-136-PSD).
 - C. Discussion of public space permit application for an outdoor patio at the Capitol Square Bar and Grill at 1500 East Capitol Street (Tracking # 10852880).
 - D. Update on Tennessee Avenue NE traffic calming. Will Handsfield from DDOT will present. (will be discussed at the end of the meeting to accommodate scheduling).
- IV. New Business
 - A. Discussion of public space permit application for an outdoor patio at Bullfrog Bagels on H Street NE (Tracking # 10854279)
 - B. Discussion of fence permit at 1369 C St NE (Will Handsfield, in his personal capacity).
 - C. Discussion of installing a speed hump in the 1500 block of Isherwood Street NE.
 - D. Discussion of converting stoplights to 4-way stops (time permitting).
- V. Community Comment (time permitting)
- VII. Adjourn meeting



MURIEL BOWSER
MAYOR

April 23, 2021

The Honorable Phil Mendelson
Chairman
Council of the District of Columbia
John A. Wilson Building
1350 Pennsylvania Avenue, N.W.
Suite 504
Washington, D.C. 20004

Dear Chairman Mendelson:

Attached, please find the '*Public Restroom Facilities and Promotion Act of 2018: Report on the Sites with Frequent Incidents of Public Defecation and Urination.*' This report is being submitted pursuant to the reporting requirements of DC Official Code § 10-1052(b).

If you have any questions, please contact Keith A. Anderson, Director, Department of General Services, at (202) 727-2800.

Sincerely,

A handwritten signature in black ink that reads "Muriel Bowser".

Muriel Bowser

Enclosures



Public Restroom Facilities and Promotion Act of 2018:

*Report on the Sites with Frequent Incidents of
Public Defecation and Urination*



*Prepared by the Department of General Services
March 12, 2021*

TABLE OF CONTENTS

I. ACRONYMS AND DEFINITIONS.....	3
II. OVERVIEW: PUBLIC RESTROOM FACILITIES AND PROMOTION ACT OF 2018.....	5
Overview of Law.....	5
Purpose of Report.....	5
III. SUMMARY OF FINDINGS.....	7
District Agencies	7
Information Gathered from District Agencies	7
Areas of Common Recommendation and/or Servicing	8
ANCs, BIDs and Clean Teams	9
Information Gathered from ANCs, BIDs and Clean Teams	9
Community Recommendations for Public Restroom Locations	10
Commonalities: Community and Government	10
Feedback Implications	11
Next Steps	11
IV. APPENDICES.....	13
Appendix I: MPD Recommendations for Public Restroom Location, by Police District	13
Appendix II: Survey Questions and Responses	14

I. ACRONYMS AND DEFINITIONS

ACRONYMS

ANC – Advisory Neighborhood Commission

BID – Business Improvement District

DDOT – District Department of Transportation

DGS – Department of General Services

DHS – Department of Human Services

DMPED – Deputy Mayor for Planning and Economic Development

DOH – Department of Health / DC Health

DPR – Department of Parks and Recreation

DPW – Department of Public Works

DSLBD – Department of Small and Local Business Development

MPD – Metropolitan Police Department

OCA – Office of the City Administrator - Internal Services Division

DEFINITIONS

Advisory Neighborhood Commission – An Advisory Neighborhood Commission (ANC) is a non-partisan, neighborhood body comprised of locally elected representatives called Advisory Neighborhood Commissioners (ANCs).

Business Improvement District – A Business Improvement District (BID) is a self-taxing district established by property owners to enhance the economic vitality of a specific commercial area. The tax is a surcharge to the real property tax liability. The tax is collected by the District of Columbia and all revenues are returned entirely to the nonprofit organization managing the BID. Business and property owners control the BID and how funds are spent. There are currently 11 BIDs in the District of Columbia.

Clean Team – The Department of Small and Local Business Development (DSLBD) funds and monitors the District's Commercial Clean Team Program, which is managed by the Commercial Revitalization Division within the agency. Basic services of Clean Teams include improving the appearance of the District's commercial corridors, reducing litter, graffiti and posters,

maintaining a healthy tree canopy, including landscaping along the corridor and supporting Sustainable D.C. goals by recycling, mulching, using eco-friendly supplies and reducing storm-water pollution generated by the city's commercial corridors.

Human Waste – Human feces and/or urine.

Public Restrooms Act – Alternately referenced as 'law' herein; D.C. Law 22-280– Public Restrooms Facilities Installation and Promotion Act of 2018 – was passed in April 2019 to establish a Working Group consisting of nine (9) agencies and five (5) Mayoral appointed community members to direct the Mayor to establish a public restroom facilities pilot program and install two public restroom facilities in high-need locations in the District; and to establish the Community Restroom Incentive Pilot Program to provide financial incentives to places of public accommodations in a selected Business Improvement District that open their restrooms for public use. Funding for the Community Restroom Incentive Pilot Program has been suspended due to the COVID-19 pandemic.

II. OVERVIEW: PUBLIC RESTROOM FACILITIES AND PROMOTION ACT OF 2018

Overview of Law

In April 2019, the DC Council and the Mayor enacted the 'Public Restroom Facilities Installation and Promotion Act of 2018.' This law directs the District to work toward the following¹:

1. Solicit feedback from Business Improvement Districts (BIDs), Advisory Neighborhood Commissions (ANCs), and Clean Teams on potential locations for two pilot sites for 24/7 public restroom facilities;
2. Submit a report from the Mayor to Council with locations of sites with at least ten incidents of public urination and/or defecation resulting in dispatch of staff;
3. Establish a Working Group consisting of nine (9) District government agencies and five (5) community members to recommend locations for stand-alone public restrooms in a pilot program;
4. Engage communities on the Working Group's recommendations, and;
5. Install two stand-alone public restrooms.

Purpose of Report

This report summarizes feedback from District agencies that are required to participate in the Working Group as well as feedback from ANCs, BIDs and Clean Teams. Additionally, this report details information on top areas in the city where public defecation and urination problems persist, to the extent that such data exist. This report also outlines preliminary recommendations that have surfaced in conversations thus far.

The nine (9) agencies that are mandated to participate in the Working Group are:

- Department of Human Services (DHS)
- District Department of Transportation (DDOT)
- Metropolitan Police Department (MPD)
- DC Department of Health (DOH / DC Health)

¹ Not all milestones in the Public Restrooms Facilities and Promotion Act of 2018 are referenced. Please refer to the legislation for additional information.

- Department of Parks and Recreation (DPR)
- Deputy Mayor for Planning and Economic Development (DMPED)
- Department of General Services (DGS)
- Department of Public Works (DPW)
- DC Water

In addition to convening nine (9) government agencies, the Working Group must also include five (5) community members. The community members must meet the following criteria, as specified in the Act.:

- Representatives of non-profits with a focus on homelessness (2)
- Representative of a non-profit with a focus on seniors (1)
- Representatives of a non-profit with a focus on public health (1)
- An individual with experience in urban planning (1)

The Public Restroom Facilities Installation and Promotion Act of 2018 requires that the 14-member Working Group convene its first meeting within sixty days of publication of this report.

III. SUMMARY OF FINDINGS

District Agencies

The law requires this report to include data on the locations that experience at least ten calls for service for human waste problems resulting in dispatch; however, this type of specific data is unavailable. The District's 311 service and the Metropolitan Police Department (MPD) have confirmed there is no specific reporting category for public urination or defecation. Instead, incidents under these two categories are incorporated into larger reporting categories complicating data analysis efforts.

As a substitute, representatives from the government agencies referenced in the statute met on September 17, 2020 to discuss and share any available data, even if anecdotal, related to human waste. Attendees included:

1. DHS representative
2. DDOT representative
3. MPD representative
4. DC Health representative
5. DPR representative
6. DMPED representative
7. Several representatives from DGS

Separately, DGS met with DPW representatives who were unable to attend the meeting.

In addition, the group identified areas which the working group could consider, such as data gaps, the importance of community engagement, security, vandalism, and cleanliness.

Information Gathered from District Agencies

Few agencies had anecdotal data relating to where problems of public defecation and urination occur most frequently. Most agencies did not have direct experience responding to these types of complaints.

DPW was the only agency with documentation about responding to such issues. The agency holds a contract with a vendor that specializes in biohazard removal. This contractor visits the following locations, with frequencies in parentheses:

- 2nd & L & M St., NE (twice per month)
- 27th & K St., NW (once per month)
- New Jersey & O St., NW (four times per month)
- 2nd & D St., NW (once per month)
- 3rd & Virginia Ave., SE (once per month)

- New York Ave & Montana Ave., NE (once per month)

Additionally, the contractor makes emergency visits on an as-needed basis. During the summer months of 2020, the contractor visited the following sites, with number of emergency visits in parentheses:

- 27th & K St., NW (4)
- 3rd & Virginia Ave., SE (2)
- New York Ave & Montana Ave., NE (2)

DHS placed portable, temporary restrooms at various locations across the city at the onset of the pandemic. These restrooms are located in areas with high numbers of individuals experiencing homelessness. Locations of DHS portable restrooms are as follows:

- 3rd & L St., NE
- Dupont Circle, NW
- M & Delaware Ave., NE
- 26th & I St., NW
- 3rd & Virginia Ave., SE
- 4th & O St., NW
- 21st & East St., NW
- 14th & K St., NW
- 14th and Park Road, NW

DPR is also planning to complete their installation of two standalone public restrooms in the spring of 2021. One restroom will be located at Oxon Run Park in Ward 8, and the other at Walter Pierce Park in Ward 1. DPR selected these locations based on previous conversations with community members who expressed interest in installing a public restroom at recreation facilities. DPR also considered the amount of foot traffic in the vicinity and whether these locations allowed the agency to place the restroom close to lighting and street traffic.

At the time of the September 17th meeting, MPD had already drafted a list of recommended locations for public restrooms. Importantly, these recommendations are based on observations rather than hard data; see Appendix I for MPD's complete list of locations.

Areas of Common Recommendation and/or Servicing

Several locations throughout the city emerged as high priority areas for District agencies. DPW and DHS reported their on-the-ground experiences with problems of public human waste while MPD made recommendations and DPR selected two parks as future sites of public restrooms.

Below is a list of the intersections that two or more of these four agencies have considered:

- L Street, NE corridor (between 1st Street, NW and 3rd Street, NW) in NoMA. Both DPW and DHS serve this area and MPD recommends placement of a public restroom at this location.
- Foggy Bottom (27th and K Street, NW). DPW's biohazard contractor has made emergency visits recently and DHS has placed a temporary restroom here.
- Columbia Heights (14th Street and Park Road, NW). DHS placed a temporary restroom here and MPD included this site in their recommendations.
- New Jersey Avenue, NW and O Street, NW. DHS placed a temporary restroom here and DPW's biohazard contractor visits this location four times per month, indicating that the site needs weekly maintenance due to human waste.
- 400 2nd Street, NW. MPD recommended this location and DPW's biohazard contractor has visits this location once per month.

ANCs, BIDs and Clean Teams

On September 30, 2020, a survey was distributed to ANCs, BIDs and Clean Teams requesting feedback on the topic of public restrooms (see Appendix II for survey questions and results).² Of the 328 recipients, 52 Advisory Neighborhood Commissioners (ANC)³ five BIDs, and one Clean Team responded. There were 23 additional respondents.

Information Gathered from ANCs, BIDs and Clean Teams

The majority of respondents supported the installation of public restrooms. Many respondents expressed interest in having follow-up conversations to learn more about the District's efforts on this topic, and to further share ideas. Suggestions from respondents included:

² The category 'Other' was included in the survey in the event entities outside of these groups received and responded to the survey. The "Other" category represents residents, community advocates, civic associations, residents and/or other interested parties.

³ The survey was developed with the intention to elicit responses from Advisory Neighborhood Commissions (ANCs) regarding community feedback on the topic of public restrooms. Some ANC Commissioners responded independently.

Survey Highlights

- 85% of respondents supported the District’s public restrooms efforts
 - 86% of respondents witnessed and 81% encountered incidents of public defecation and/or urination at least once a year
 - 29% of respondents recommended locations for public restrooms outside of their neighborhood
- Locate public restrooms near other public facilities areas such as metro stations, police or fire stations
 - Ensure locations have attendants that can monitor public restrooms, with a hiring preference for individuals experiencing homelessness; or, provide self-cleaning facilities
 - Incorporate public restrooms in a brick and mortar or new development
 - Prioritize regular cleaning and maintenance, design not susceptible to vandalism, accessibility, usage monitoring/data collection, and safety

Community Recommendations for Public Restroom Locations

ANCs, BIDs and Clean Teams were asked about specific recommendations for public restroom locations in their neighborhood/service areas. Respondents provided 103 distinct locations, 19 of which received more than one recommendation (see Appendix II for more information).

- Ward 3 respondents indicated the desire to place public restrooms in other areas of the District, or near metro stations.
- Ward 6 had the highest number of respondents reporting ‘Yes’ to either encountering or witnessing human waste in their neighborhood/service area.

Commonalities: Community and Government

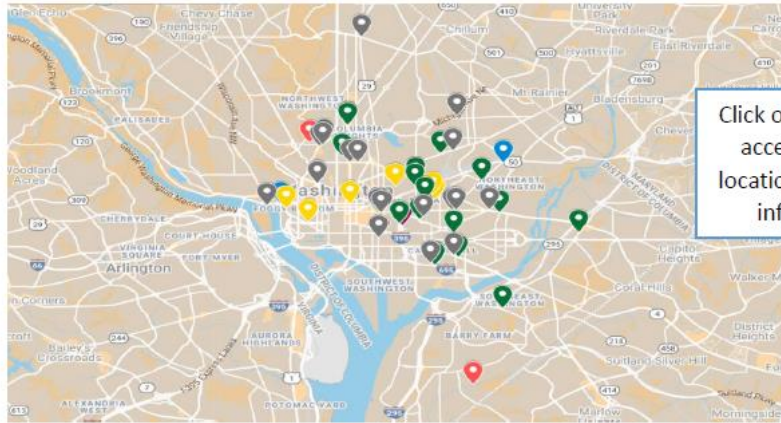

Click on the chart to access a map of locations for further information.

In the above image, blue dots represent sites where DPW has performed emergency cleanings; purple dots represent other DPW sites that a biohazard contractor services; yellow dots represent temporary DHS restrooms; green dots represent MPD recommendations; and pink dots reflect future DPR sites of standalone public restrooms.

Survey respondents identified 19 locations that received two or more recommendations⁴ from community members. These 19 locations were compared with those that government agencies had serviced or recommended. Below are the rough geographical areas that government agencies and multiple community members both suggested as potential public restroom locations:

- 27th and K Street, NW: DPW's biohazard contractor has made multiple emergency visits to this area, DHS placed a temporary restroom here, and community members identified the nearby Georgetown Waterfront as a potential location.
- 3rd Street and Virginia Avenue, SE: MPD and community members recommended this location for a public restroom, and DHS placed a temporary restroom here.
- Gallery Place NW: MPD and community members recommended this location for a public restroom.
- Dupont Circle, NW: DHS placed a temporary restroom near the circle and community members also recommended this location for a public restroom.
- Near Union Station, NW: MPD and community members suggested placing a public restroom near this location.
- 17th Street and Benning Road, NE: MPD and community members suggested placing a public restroom near this intersection.

Feedback Implications

There is overwhelming community support from survey respondents for public restrooms in the District. Additionally, survey respondents requested more community engagement; they asked for a process that carefully considers public restroom locations with a heavy emphasis on community buy-in.

There is equal concern, both among community members and District government representatives, for public health and safety, specifically routine maintenance and security to prevent an increase in vandalism or other types of crime.

Finally, there are several locations across the District that agencies and members of the community agree are eligible sites for public restrooms. The accounting of those recommendations provided above can serve as a guide for Working Group members as they draft their own recommendations for stand-alone public restroom locations.

Next Steps

The public restrooms Act outlines specific steps necessary to implement this program and install the stand-alone restrooms. The next major milestones as required by the statute are as follows:

- **Mayor Names Public Restroom Working Group:** 30 days after publication of this report

⁴ There were 20 locations that multiple community members recommended, but one location – “downtown business district” – was too vague to be included in our analysis.

- **Working Group Convenes Initial Meeting:** 30 days after Mayor names Public Restrooms Working Group

In 60 days, the Working Group will begin the process of establishing a public restroom facilities pilot program, which will culminate in the installation of two public restroom facilities.

IV. APPENDICES

Appendix I: MPD Recommendations for Public Restroom Location, by Police District

Possible Locations for a Public Restroom

First District

1. 3rd and Virginia, SE
2. 9th and Penn, SE
3. 50 Mass Ave., NE (around Union Station),
4. 400 blk of 2nd St., NW
5. Gallery Place

Third District

1. North Capitol/Florida Ave., NW
2. Columbia Heights area (14th/Kenyon and Irving)
3. 15th and Florida Ave., NW – near Meridian Hill Park
4. North Capitol/O Streets, NW

Fifth District

1. West Virginia Ave., & Mt. Olivet Rd., NE (there is open space on the northwest corner that is bounded by a fence)
2. North Capitol St. & Florida Ave., NE
3. 100 blocks of either K, L, or M Sts., NE
4. 17th & Benning Rd., NE (Laundromat area)
5. 4th & Rhode Island Ave., NE

Sixth District

1. 3800- 3900 block of Minnesota Ave., NE - this is a business corridor which is populated with individuals experiencing homelessness, drug addiction, and mental illness.
2. The Good Hope Road Corridor shared by both 6th and 7th Districts. This would be for the same reasons as above, with the addition of prostitution.

Appendix II: Survey Questions and Responses

What organization do you represent? If other, please specify in "Other" ⁵

Entity	# of Responses
Advisory Neighborhood Commissioners (ANCs)	52
Business Improvement District (BID)	5
DC Clean Team	1
Other	23
TOTAL RESPONSES =	81

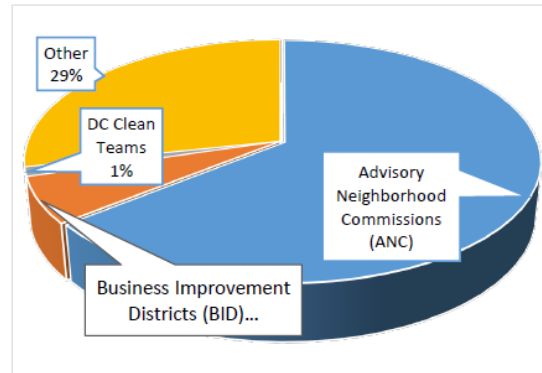

Which Ward do you service or represent?

- Ward 1 = 12 responses
- Ward 2 = 11 responses
- Ward 3 = 3 responses
- Ward 4 = 9 responses
- Ward 5 = 17 responses
- Ward 6 = 23 responses
- Ward 7 = 2 responses
- Ward 8 = 4 responses

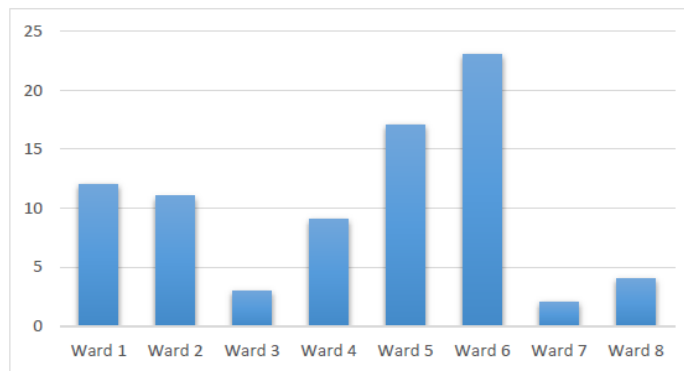

Ward-Specific Neighborhood Responses (number of responses by neighborhood are in parenthesis):

- **Ward 1** = Adams Morgan (3), Cardozo/Shaw (4), Columbia Heights (5), Howard University (2), LeDroit Park (2), Park View (2), and Pleasant Plains (2)
- **Ward 2** = Burleith/Hillandale (1), Chinatown (3), Downtown (3), Downtown East (1), Dupont Circle (4), Foggy Bottom (1), George Washington Univ (1), Georgetown (2), Penn Quarter (1)
- **Ward 3** – Cathedral Heights (1), Foxhill Village (1), Friendship Heights (1), Georgetown Reservoir (1), Glover Park (1), Palisades (1), Spring Valley (1), Wesley Heights (1)

⁵ This survey was disseminated to ANCs, BIDs and Clean Teams, a feedback requirement mandated by law. The category 'Other' was included in the survey in the event entities outside of these groups received and responded to the survey. The "Other" category represents residents, community advocates, civic associations, residents and/or other interested parties.

How frequently do you encounter (see) discarded feces or urination in your neighborhood?

Response	# of Responses
Never	14
A few times a year	25
At least once a month	15
At least once a week	13
Daily	8

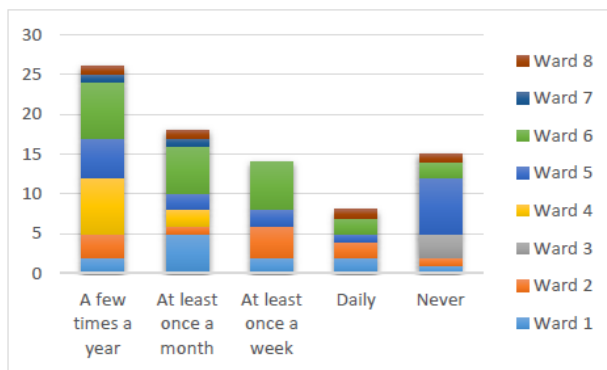
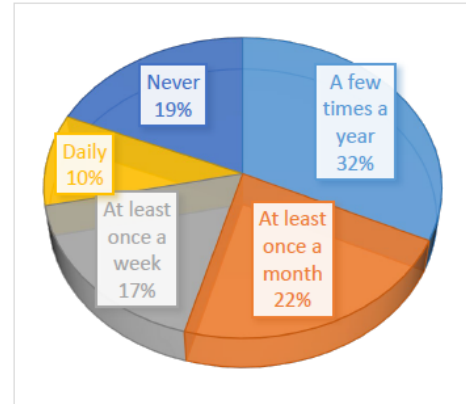

Are the recommendation(s) (you are making for a public restroom location) outside of your ANC or neighborhood?

Response	# of Responses
Yes	22
No	54

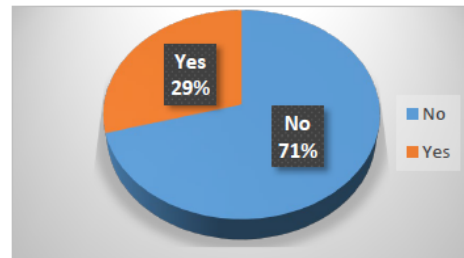

What are your recommendation(s) for stand-alone restrooms (respondents could choose 2)

Listing of Locations	# of Recommendations
11th and Monroe Streets, NW	1
12th and Franklin Streets, NE	1
12th and H Street, NE	1
12th and Monroe Streets, NE	1
12th Street, NE and Michigan Ave, NE	1
14th and Constitution Avenue NW	1
14th and E Street, NW	1
14th and Girard Streets, NW	1
14th and Spring Rd, NW	1
14th and U Streets, NW (Reeves Center)	7
14th and V Streets, NW	1
14th Street and Spring Road, NW	1
16th and H Street Streets, NW	1
1700 block of Columbia Road, NW	1
17th Street Corridor (1704 Columbia Rd or 1747 Columbia Rd NW -side of the Safeway building, near Ontario Rd NW)	3
3rd Street Corridor	1
5th and Pennsylvania Avenue, SE	1
7th and D Streets, NW	1
7th and H Street, NE (by DC public services building)	2
7th and H Streets, NW	2
8th & H Street, NE	1
8th and D, SE	1
8th and H Streets, NE	5
8th Street (Under the freeway)	1
Adams Morgan (at or near 18th St and Columbia Road)	3
Atlantic Street and Livingston Road, SE	1
Bladensburg Road between South Dakota and New York Avenue	1
Buzzard Point	1
Civic Plaza	1
Columbia Heights (near intersection of 14th and Kenyon Sts, NW)	1
Congress Heights near St. Elizabeth's campus	1
Corner of North Capitol Street, NW and Florida Avenue NW (gated triangle park)	1
Corner of North Capitol Street NE, Lincoln Road NE, and Quincy Place, NE	1
Cross streets of Taylor/Upshur and Georgia Avenue	1
Downtown business district	2
Dupont Circle	4
Dupont Circle (P Street and Massachusetts Avenue)	1

Listing of Locations	# of Recommendations
East of North Capitol on New York Avenue, NE (McDonald's parking lot)	1
Near Eastern Market Metro Plaza Park -- 800 Pennsylvania Ave	1
Near Eastern Market Metro Station (Plaza at 7th and Pennsylvania Avenue, SE)	1
8th Street, SE (at SE expressway overpass - Marine Barracks)	1
Gallery Place (9th and G Streets, NW)	2
Galveston Street and South Capitol Street	1
Garfield Park (Near the I-695 overpass/homeless encampments abutting park)	4
Georgetown (by M Street and Wisconsin Avenue, NW)	1
Georgetown Library - Wisconsin and R Streets - the garden behind	1
Georgetown Waterfront (K Street)	2
Georgia and Lamont St NW	1
Georgia and New Hampshire Avenues, NW	1
Georgia Avenue and Upshur Street, NW	1
Georgia and Missouri Avenues, NW (near park)	2
Golden Triangle	1
Historic Anacostia (near the Big Chair)	1
Near Tenleytown Metro Station (intersection of Wisconsin Avenue and Albemarle Street, NW)	1
Near Friendship Heights Metrorail stations (along Wisconsin Ave between Jennifer Street and Western Avenue, NW)	1
Intersection of Military/Missouri Roads and Georgia Avenue, NW	1
Kalorama Park (intersection of Columbia Rd, NW, Kalorama Rd., NW, and 19th St., NW)	1
Massachusetts Avenue and 14th Street	1
McPherson Square, NW	1
National Mall (adjacent to the Mall along Constitution Ave NW)	3
Near (rear) of So Others Might Eat (SOME) , between North Capitol and First St., NW, 2 or 3 blocks north of New York Avenue, NW	1
Near 12th and Newton	1
Near Brookland Metro Station (Michigan Ave. & 10th St.)	3
Near Convention Center (7th St and M St NW)	1
Near Deanwood Metro Station	1
Near Dupont Circle	1
Near Eastern Market (Near east bldg. Eastern Market and Rumsey Pool)	1
Near Eastern Market metro station (Pennsylvania Avenue and 7th/8th Streets, SE)	3
North Capital Street (Near fire station)	1
Near Fort Slocum Park (without impeding on NPS land)	1
Near Logan Circle (south side between O St, 13th St, and the Logan Circle, NW).	1
Near Metro Center Metro Station (11th and G Streets, NW)	1

Listing of Locations	# of Recommendations
Near Montrose Park	1
Near Petworth Library and Mac Farland/triangle area near Georgia avenue/Varnum/Upshur	1
Near Petworth Metro Station (Georgia Ave NW and New Hampshire Ave NW)	1
Near Post Office on Pennsylvania Ave SE (cross street is L'Enfant Square/Minnesota Ave, Ward 7, SE quadrant)	1
Near public facilities areas like metro stations, police or fire stations	1
Near Rhode Island Avenue Metro Station (10th and Rhode Island, or W Street, NE near MBT entrance)	3
Near SE Public Library	1
Near Takoma Metro Station (On the grounds, or around 327 Cedar Street, NW)	1
Near the intersection of Wards 1 and 5 in the Shaw neighborhood	1
Near U Street Metro stop (13th and U Streets)	2
Near Virginia Avenue and 3rd St, SE	1
New Hampshire and Georgia Avenues, NW	1
NoMa	1
Park Rd and 14th Street, NW	1
Rhode Island Ave & 5th Street, NE (by fire station)	1
Rhode Island Avenue between 13th & 18th Streets	1
Seward Square	1
Somewhere in ANC 1B	1
South Capitol and First Streets, SW	1
Southeast Side of Thomas Circle (above the Massachusetts Ave NW overpass)	1
Stanton Park (at the end of the 700 block of 8th St NE by H Street, NE)	1
Starburst Plaza (near Hechinger Mall-Benning & Maryland intersection, or Bladensburg and H Street, NE)	2
Triangle at 13th, East Capitol and North Carolina Ave NE	1
Triangle at Massachusetts (East Capitol and 13th Streets, SE)	1
Under railroad tracks on K Street/L Street, NE	1
Union Station	2
Unity Park (triangle park bordered by Columbia Rd, NW, Euclid St. NW, and Champlain St., NW)	2
Upshot and 14th Streets, NW	1
Valley Ave (between Wheeler Road and 13th Street, SE)	1
Vermont and K Streets, NW	1
Washington Circle	1

Government of the District of Columbia
Department of Transportation



d. Planning & Sustainability Division

April 22, 2021

Commissioner Amber Gove
Chair, Advisory Neighborhood Commission 6A
1216 Constitution Avenue NE
Washington, DC 20002
Via Email: 6A04@anc.dc.gov

NOI # 21-136-PSD

Re: Notification for the Installation of one-way protected bikeways in the 800 and 900 blocks of West Virginia Avenue NE

Dear Chair Gove,

Pursuant to the “Administrative Procedure Amendment Act of 2000” D.C. LAW 13-249 (48 DCR 3491 April 20, 2001), the District Department of Transportation (DDOT) is required to give a written notice of our intent to install one-way advisory bikeways on the 800 block and one-way protected bikeways on the 900 block of West Virginia Avenue NE. This letter is being forwarded to you for the purpose of notification and solicitation of comments on our intent to implement the following in your jurisdiction.

DDOT proposes to:

- Install one-way advisory bikeways on the 800 block of West Virginia Avenue NE
- Install one-way protected bikeways on the 900 block of West Virginia Avenue NE.

The existing condition of West Virginia Avenue NE in this area is a single wide travel lane with curbside parking on the south side of the 800 block of West Virginia Avenue NE and no parking in the 900 block. Adding advisory and protected bicycle lanes on this corridor will help people on bicycles stay safe while riding along the corridor and provide safe bicycle routes for those heading to and from the Ivy City neighborhood. The existing curb-to-curb width of West Virginia Avenue NE allows DDOT to add these advisory and protected bikeways while retaining

parking spaces and reducing lane sizes to a safer width. DDOT is considering potentially converting the 800 block of West Virginia Avenue NE one-way for vehicular traffic to facilitate one-way protected bikeways while retaining parking.

This design will improve safety along the corridor by reducing instances of speeding, shortening the effective crossing distance for pedestrians, and providing physical and spatial separation between people on bicycles and general motor traffic on the corridor from 8th Street through New York Avenue NE. Research and experience suggest that the reduction in width to the travel lane will reduce speeding in the corridor.

DDOT anticipates the following benefits:

- Slower vehicular speeds and improved compliance with traffic control devices
- Comfortable bicycling facilities for people traveling in and through the corridor
- Improved safety due to reduction of existing conflicts.

This segment is an important step in expanding the protected bicycle lane network, now also used by scooters and other personal mobility devices, in the District of Columbia. Adding these facilities is an important part of DDOT's work to improve safety for all roadway users. The West Virginia Avenue NE corridor is a popular route for cycling to and from businesses on the corridor and the nearby businesses and residences in Ivy City and will connect to the future multi-use trail planned for New York Avenue NE and protected bikeways on Florida Avenue NE to the north and the painted bikeways on K Street NE to the south.

All comments on this subject matter must be filed in writing, no later than July 6, 2021, fifty-one (51) business days after the date of this notice, with the District Department of Transportation Planning and Sustainability Division, 250 M Street SE, 5th Floor, Washington, DC, 20003 or via email at greg.matlesky@dc.gov. If you would like to check the status of this Notice of Intent (NOI), please visit DDOT's website at <https://wiki.ddot.dc.gov/display/NOI>. In addition, if you have questions, have trouble accessing the NOI site or are unable to do so, please contact me at 202-497-5086.

Sincerely,



Greg Matlesky
Bicycle Program Specialist
Planning & Sustainability Division

Cc: Keya Chatterjee, Commissioner, ANC 6A01
Nyasha Smith, Secretary to the Council of the District of Columbia
Talib Shakir, Ward 6 Liaison, Mayor's Office of Community Relations & Services
Isamar Vaquero, Ward 6 Liaison, Mayor's Office of Community Relations & Services
Anna Chamberlin, Associate Director of Planning & Sustainability Division, DDOT

George Branyan, Active Transportation Branch Manager, DDOT
Andrew DeFrank, Ward 6 Community Engagement Specialist, DDOT

CAPITOL SQUARE BAR & GRILL OUTDOOR SEATING PLAN 1500 EAST CAPITOL STREET, NE WASHINGTON, DC 20003

CAPITOL SQUARE BAR & GRILL
1500 EAST CAPITOL STREET, NE
WASHINGTON, DC 20003
OWNER: SUPRA, LLC
ARCHITECT: SUPRA, LLC
DATE: 08/20/2024

GENERAL NOTES	
1.	SEE ARCHITECT'S PLAN FOR SEATING LAYOUT
2.	SEE ARCHITECT'S PLAN FOR SEATING LAYOUT
3.	SEE ARCHITECT'S PLAN FOR SEATING LAYOUT
4.	SEE ARCHITECT'S PLAN FOR SEATING LAYOUT
5.	SEE ARCHITECT'S PLAN FOR SEATING LAYOUT

GENERAL NOTES	
1.	SEE ARCHITECT'S PLAN FOR SEATING LAYOUT
2.	SEE ARCHITECT'S PLAN FOR SEATING LAYOUT
3.	SEE ARCHITECT'S PLAN FOR SEATING LAYOUT
4.	SEE ARCHITECT'S PLAN FOR SEATING LAYOUT
5.	SEE ARCHITECT'S PLAN FOR SEATING LAYOUT



COVER SHEET

CAPITOL SQUARE
BAR & GRILL
1500 EAST
CAPITOL ST. N.E.
WASHINGTON, DC 20003

DATE	
REVISION	
NO.	
DESCRIPTION	
DATE	

CHARLES DEWITT ARCHITECT, INC.
1500 EAST CAPITOL STREET, NE
WASHINGTON, DC 20003

CAPITOL SQUARE BAR & GRILL OUTDOOR SEATING AREA

- GENERAL NOTES**
1. AREA TOTAL AREA IS 57' PROPOSED OUTDOOR SEATING AREA
 2. TABLES - 12' BY 48" 3' TALL 28' BY 28"
 3. DISTANCE BETWEEN CHAIRS MAXIMUM 4'
 4. DISTANCE FROM 15 ST. CURB 8'
 5. DISTANCE FROM E. CAPITOL STREET 16'
 6. WORK STATION
 7. TRAFFIC LIGHT POLE
 8. UMBRELLA MAXIMUM HEIGHT TO 8'0" IF FENCE / BARRIER HEIGHT MAXIMUM 3'
 9. FENCE / BARRIER MAXIMUM 3'
 10. NAME PARKER BIN
 11. CONDO - 18' BUFFER ZONE

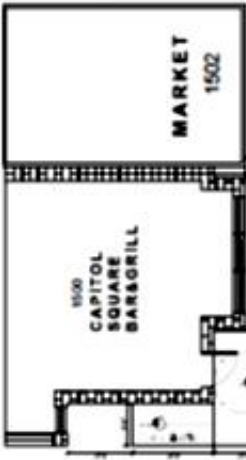
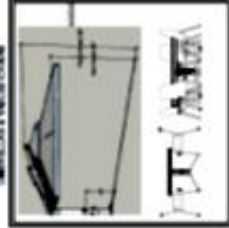
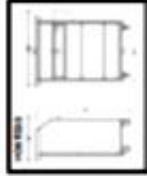

15 ST.



1500

E. CAPITOL ST.

OUTDOOR SEATING AREA

CAPITOL SQUARE
BAR & GRILL
1500 EAST
CAPITOL ST. N.E.
WASHINGTON, DC 20003

SCALE: 1/8" = 1'-0"

NO.	DATE	REVISION
1	10/15/11	ISSUE FOR PERMIT
2	11/15/11	REVISED PER COMMENTS
3	12/15/11	REVISED PER COMMENTS
4	01/15/12	REVISED PER COMMENTS
5	02/15/12	REVISED PER COMMENTS
6	03/15/12	REVISED PER COMMENTS
7	04/15/12	REVISED PER COMMENTS
8	05/15/12	REVISED PER COMMENTS
9	06/15/12	REVISED PER COMMENTS
10	07/15/12	REVISED PER COMMENTS
11	08/15/12	REVISED PER COMMENTS
12	09/15/12	REVISED PER COMMENTS
13	10/15/12	REVISED PER COMMENTS
14	11/15/12	REVISED PER COMMENTS
15	12/15/12	REVISED PER COMMENTS

FLOOR PLANS

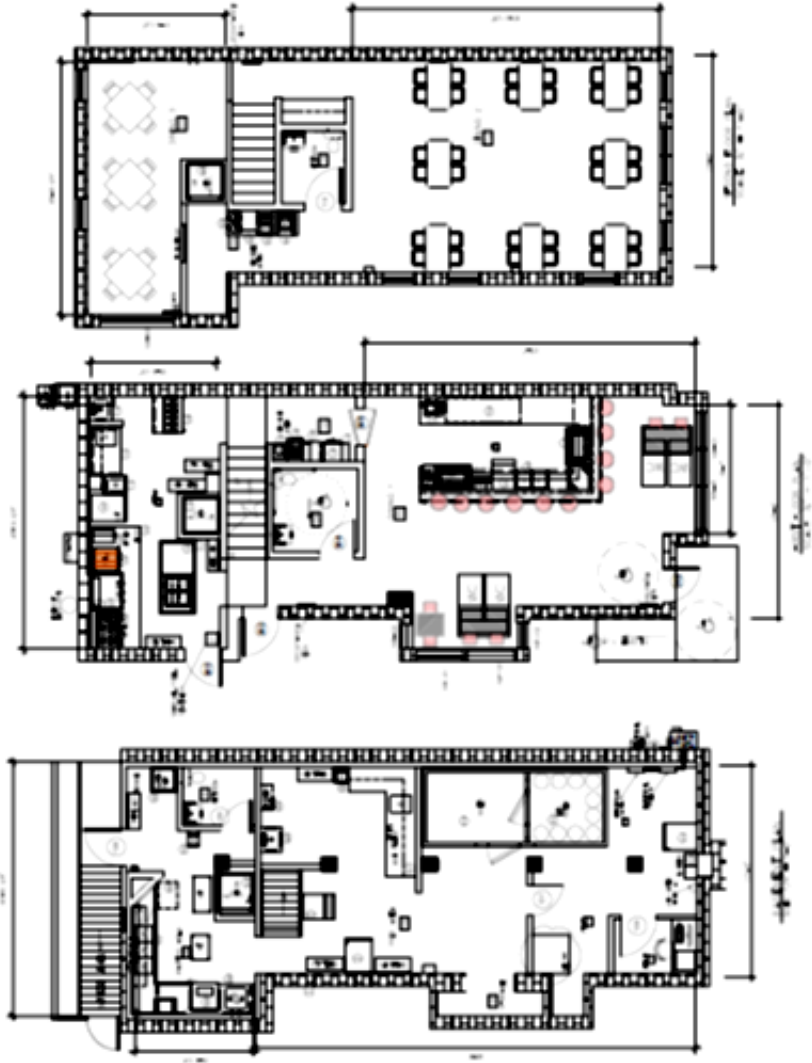

FLOOR PLANS LAYOUT:
BATHROOMS
ARE PROVIDED
IN EACH LEVEL

CAPTOL SQUARE BAR/GRILL 1500 EAST CAPITOL ST. N.E. WASHINGTON, DC 20003		FLOOR PLAN LAYOUT		CHARTER DEVELOPMENT, INC. 1500 EAST CAPITOL ST. N.E. WASHINGTON, DC 20003	
NO.	DATE	NO.	DATE	NO.	DATE



Dr. Lucius M. Dalton
Senior Pastor

Calvin Holloway
Chair of Deacon Ministry

James L. Hill Jr.
Chair of Trustee Ministry

Carolyn McCrea
Church Clerk

Chola Dawkins
Church Treasurer

April 29, 2021

To whom it may concern,

Please accept this letter of full support of The D.C. Capitol Square Bar & Grill L.L.C. and their goal in bringing the much-needed healthy food options to our area. Mount Moriah Baptist Church, which was founded in 1885, came to our present location, establishing ourselves in the Richard Hill community and has served this diverse community for over 63 years.

While building relationships within the Richard Hill community, we have observed that there aren't any restaurants in our community.

A restaurant is an excellent addition to our area, and to show our full support, we, Mt. Moriah Baptist Church, will allow the establishment to use our parking area at 17th and East Capitol Street N.E. for their customers to minimize street parking.

We believe the restaurant will bring healthy and delicious food to our community and create part-time, full-time and walking distance employment for people in our community. Mt. Moriah is offering her full support.

If I can be of any further assistance, please do not hesitate to contact me.

Sincerely,

Dr. Lucius M. Dalton
Senior Pastor

Office:
202.544.5588

Web:
mountmoriahchurch.org

1636 East Capitol Street, NE
Washington, DC 20003

Becoming. Better. Together. John 15:2

April 21, 2021

Dear ANC6A Neighbors,

In the next few weeks, the DC Department of Transportation (DDOT) will install a traffic calming project on Tennessee Ave between East Capitol and 15th Streets NE. The goal is to reduce speeds and improve safety for all users, including drivers, pedestrians and cyclists.

The project includes:

- Upgrades to crosswalks and intersections to improve sightlines and bring setbacks up to current safety code (typically 25 feet for crosswalks and 10 feet for alleys);
- Installation of **advisory bike lanes** on TN Ave between Constitution and 15th St NE; and
- Installation of a **contra-flow bike lane** and **sharrows** on the 100 block of TN Ave NE.

How Did We Get Here?

In January 2019, following the recommendation of the Transportation and Public Space (TPS) Committee and requests from residents, our Commission [requested](#) traffic calming on TN Ave.

In September 2020, DDOT issued a public [Notice of Intent](#) requesting comments from residents and the Commission. DDOT also attended the September TPS Committee meeting to present the project. The Committee voted to recommend that DDOT implement the project (minutes [here](#)).

On October 1, 2020, Commissioner Gove held an informal site visit with DDOT along with 50 or so neighbors to gather additional input. On October 8, the Commission voted to send DDOT a [letter](#) of support. The Commission also requested speed humps and raised crosswalks and “minimization of any loss in linear feet of parking other than sightline setbacks required to protect vulnerable users.” The PTAs of both Maury and Miner Elementary Schools also sent letters of support for the project.



How Do Advisory Bike Lanes Work?

Visit <https://www.advisorybikelanes.com/> to see a video of this type of bike lane in action. Advisory bike lanes already exist on **E St SE between Potomac Ave and Pennsylvania Ave SE**. We encourage folks to drive/walk/bike this segment of E St SE to see how it works.

How Does a Contra-flow Bike Lane Work?

[Contra-flow bike lanes](#) have been used in DC since about 2010. The nearest contra-flow lane is on G St NE between 2nd and 13th Streets. DDOT reports that these lanes are safer than painted bike lanes and are one of the safest patterns they can apply to existing roadways (other than protected lanes).

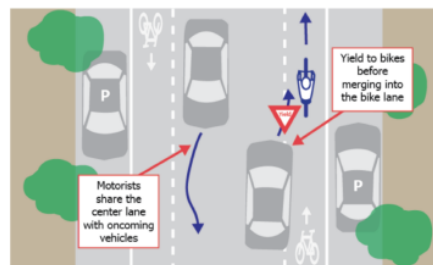

Diagram via City of Alexandria

How Do Sharrows Work?

Sharrows are painted symbols in the lane of travel designed to indicate to drivers and cyclists that they should share the lane.



Are There More Opportunities for Public Input?

Yes. You can participate in the ANC 6A TPS Committee on May 17 at 7:00pm. ANC 6A will post the agenda and Zoom link under <https://anc6a.org/agendas/>, and issue public notice of the meeting via all of our usual communication methods, including the ANC 6A [Google Group](#), [New Hill East listserv](#), ANC 6A [Facebook Group](#), [Twitter](#), and print and online editions of the [Hill Rag](#).

The DDOT project lead, Will Handsfield, will attend the May 17 TPS meeting to address the ANC's previous requests for additional speed humps, stop signs, and additional traffic calming measures for TN Ave NE. This meeting will be an opportunity for neighbors to provide input. Please also feel free to contact Will directly at William.Handsfield2@dc.gov.

What Are the Next Steps?

In the coming weeks, please keep an eye out for no parking signs and be sure to move your vehicle when notified. To improve visibility and safety for all users, we are also asking homeowners with corner lots to please help by trimming hedges along the sidewalk to 3 feet (details [here](#)).

How Can I Learn More About This Project?

Go to <https://wiki.ddot.dc.gov/display/NOI/NOI-20-79-PSD> - and see an example of existing advisory bicycle lanes on E St SE between Pennsylvania Ave/Potomac Ave.

How Can I Stay Informed?

- Learn more about our Commission at ANC6A.org
- Sign up for ANC 6A Official Announcements including meeting agendas at <https://groups.google.com/g/anc-6a>
- If you received a hard copy of this letter and would like a digital copy (to access the links) please email one of us:
 - Amber Gove, 6A04 (100-200 blocks of TN Ave) amberanc6a@gmail.com
 - Laura Gentile, 6A05 (300-400 blocks of TN Ave) 6A05@anc.dc.gov
 - Robb Dooling, 6A06 (500-600 blocks of TN Ave) 6A06@anc.dc.gov
- Join the TN Ave Google Group by contacting kenneth.w.lim@gmail.com

Thanks for your patience with this process and as we work with DDOT to make our streets safer for all users.

Best,

Amber K. Gove

Laura K. Gentile

Robb Dooling

DISTRICT OF COLUMBIA DEPARTMENT OF TRANSPORTATION



- SOURCE OF FUNDS:**
1. TITLE STREET
 2. PROJECT FUNDS & BIDDING MARKET STREET
 3. PAYMENT MACHINERY QUANTITIES
 4. PAYMENT MACHINERY & RELATED PLANS

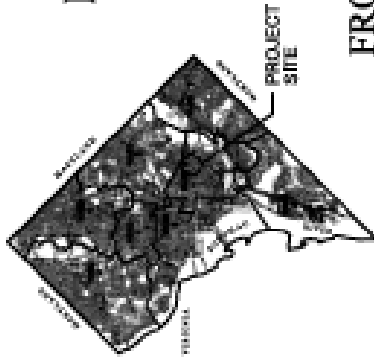

TENNESSEE AVENUE NE FROM EAST CAPITOL STREET TO 15TH STREET NE

BIKE INFRASTRUCTURE IMPROVEMENT PLANS

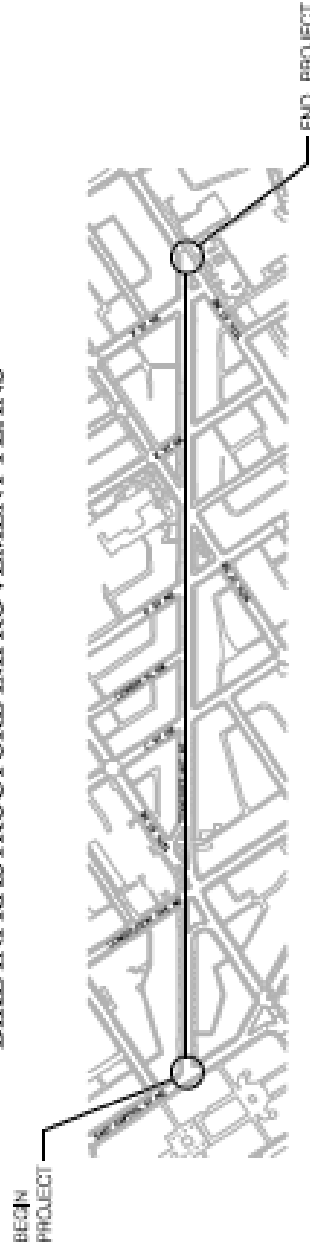

**DRAFT FINAL PLANS
NOVEMBER 2020**



SHEET NO.	

D.C. DEPARTMENT OF TRANSPORTATION PLANNING AND SUSTAINABILITY DIVISION ACTIVE TRANSPORTATION PROGRAM	
TENNESSEE AVENUE CORRIDOR BICYCLE PLANS	W-10 - SHEET
DATE:	
SCALE:	
DESIGNED BY:	
CHECKED BY:	
DATE:	
SCALE:	
DESIGNED BY:	
CHECKED BY:	
DATE:	

DATE	REVISION	BY

PROJECT NOTES
GENERAL NOTES

- ALL CONTRACTOR MATERIALS AND WORKMANSHIP SHALL BE IN ACCORDANCE WITH THE SPECIFICATIONS AND STANDARDS FOR MATERIALS AND METHODS OF CONSTRUCTION FOR THE DISTRICT OF COLUMBIA DEPARTMENT OF TRANSPORTATION. THE CONTRACTOR SHALL BE RESPONSIBLE FOR OBTAINING ALL NECESSARY PERMITS AND APPROVALS FROM THE DISTRICT OF COLUMBIA DEPARTMENT OF TRANSPORTATION.
- ALL WORK SHALL BE DONE IN ACCORDANCE WITH THE DISTRICT OF COLUMBIA DEPARTMENT OF TRANSPORTATION SPECIFICATIONS AND STANDARDS FOR MATERIALS AND METHODS OF CONSTRUCTION.
- CONTRACTOR SHALL BE RESPONSIBLE FOR OBTAINING ALL NECESSARY PERMITS AND APPROVALS FROM THE DISTRICT OF COLUMBIA DEPARTMENT OF TRANSPORTATION.
- ALL WORK SHALL BE DONE IN ACCORDANCE WITH THE DISTRICT OF COLUMBIA DEPARTMENT OF TRANSPORTATION SPECIFICATIONS AND STANDARDS FOR MATERIALS AND METHODS OF CONSTRUCTION.
- CONTRACTOR SHALL BE RESPONSIBLE FOR OBTAINING ALL NECESSARY PERMITS AND APPROVALS FROM THE DISTRICT OF COLUMBIA DEPARTMENT OF TRANSPORTATION.
- ALL CONTRACTOR MATERIALS AND WORKMANSHIP SHALL BE IN ACCORDANCE WITH THE SPECIFICATIONS AND STANDARDS FOR MATERIALS AND METHODS OF CONSTRUCTION FOR THE DISTRICT OF COLUMBIA DEPARTMENT OF TRANSPORTATION.
- CONTRACTOR SHALL BE RESPONSIBLE FOR OBTAINING ALL NECESSARY PERMITS AND APPROVALS FROM THE DISTRICT OF COLUMBIA DEPARTMENT OF TRANSPORTATION.

- SET ALL SIGN LOCATIONS AND LOCATIONS FOR SIGN SUPPORTS AND SIGN FOUNDATIONS IN ACCORDANCE WITH THE DISTRICT OF COLUMBIA DEPARTMENT OF TRANSPORTATION SPECIFICATIONS AND STANDARDS FOR MATERIALS AND METHODS OF CONSTRUCTION. THE CONTRACTOR SHALL BE RESPONSIBLE FOR OBTAINING ALL NECESSARY PERMITS AND APPROVALS FROM THE DISTRICT OF COLUMBIA DEPARTMENT OF TRANSPORTATION.
- ALL SIGN FOUNDATIONS SHALL BE CONSTRUCTED IN ACCORDANCE WITH THE DISTRICT OF COLUMBIA DEPARTMENT OF TRANSPORTATION SPECIFICATIONS AND STANDARDS FOR MATERIALS AND METHODS OF CONSTRUCTION.
- ALL SIGN SUPPORTS SHALL BE CONSTRUCTED IN ACCORDANCE WITH THE DISTRICT OF COLUMBIA DEPARTMENT OF TRANSPORTATION SPECIFICATIONS AND STANDARDS FOR MATERIALS AND METHODS OF CONSTRUCTION.
- ALL SIGN FOUNDATIONS SHALL BE CONSTRUCTED IN ACCORDANCE WITH THE DISTRICT OF COLUMBIA DEPARTMENT OF TRANSPORTATION SPECIFICATIONS AND STANDARDS FOR MATERIALS AND METHODS OF CONSTRUCTION.
- ALL SIGN SUPPORTS SHALL BE CONSTRUCTED IN ACCORDANCE WITH THE DISTRICT OF COLUMBIA DEPARTMENT OF TRANSPORTATION SPECIFICATIONS AND STANDARDS FOR MATERIALS AND METHODS OF CONSTRUCTION.
- ALL SIGN FOUNDATIONS SHALL BE CONSTRUCTED IN ACCORDANCE WITH THE DISTRICT OF COLUMBIA DEPARTMENT OF TRANSPORTATION SPECIFICATIONS AND STANDARDS FOR MATERIALS AND METHODS OF CONSTRUCTION.
- ALL SIGN SUPPORTS SHALL BE CONSTRUCTED IN ACCORDANCE WITH THE DISTRICT OF COLUMBIA DEPARTMENT OF TRANSPORTATION SPECIFICATIONS AND STANDARDS FOR MATERIALS AND METHODS OF CONSTRUCTION.
- ALL SIGN FOUNDATIONS SHALL BE CONSTRUCTED IN ACCORDANCE WITH THE DISTRICT OF COLUMBIA DEPARTMENT OF TRANSPORTATION SPECIFICATIONS AND STANDARDS FOR MATERIALS AND METHODS OF CONSTRUCTION.

- CONTRACTOR SHALL BE RESPONSIBLE FOR OBTAINING ALL NECESSARY PERMITS AND APPROVALS FROM THE DISTRICT OF COLUMBIA DEPARTMENT OF TRANSPORTATION.
- CONTRACTOR SHALL BE RESPONSIBLE FOR OBTAINING ALL NECESSARY PERMITS AND APPROVALS FROM THE DISTRICT OF COLUMBIA DEPARTMENT OF TRANSPORTATION.
- CONTRACTOR SHALL BE RESPONSIBLE FOR OBTAINING ALL NECESSARY PERMITS AND APPROVALS FROM THE DISTRICT OF COLUMBIA DEPARTMENT OF TRANSPORTATION.
- CONTRACTOR SHALL BE RESPONSIBLE FOR OBTAINING ALL NECESSARY PERMITS AND APPROVALS FROM THE DISTRICT OF COLUMBIA DEPARTMENT OF TRANSPORTATION.
- CONTRACTOR SHALL BE RESPONSIBLE FOR OBTAINING ALL NECESSARY PERMITS AND APPROVALS FROM THE DISTRICT OF COLUMBIA DEPARTMENT OF TRANSPORTATION.
- CONTRACTOR SHALL BE RESPONSIBLE FOR OBTAINING ALL NECESSARY PERMITS AND APPROVALS FROM THE DISTRICT OF COLUMBIA DEPARTMENT OF TRANSPORTATION.
- CONTRACTOR SHALL BE RESPONSIBLE FOR OBTAINING ALL NECESSARY PERMITS AND APPROVALS FROM THE DISTRICT OF COLUMBIA DEPARTMENT OF TRANSPORTATION.
- CONTRACTOR SHALL BE RESPONSIBLE FOR OBTAINING ALL NECESSARY PERMITS AND APPROVALS FROM THE DISTRICT OF COLUMBIA DEPARTMENT OF TRANSPORTATION.

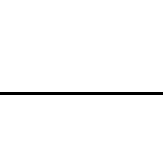
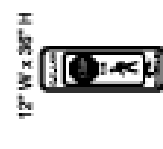
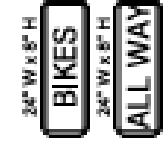
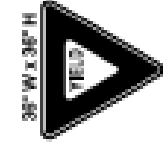
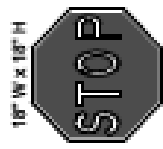

RT-1
N/A

RT-2
N/A

RT-3P (MCO)
N/A

RT-4
N/A

RT-6a
N/A

RT-17
N/A

RT-1 (L) & (R)
N/A

RT-23a (L) & (R)
N/A

RT-106a (L) & (R)
N/A

Sign Designation	Material/Stock	Sign Type	Use	Sign or Signage Description	Quantity	Panel Dimensions (ft)	Total Area (sq ft)
RT-1	MUTCD	Regulatory	Motor Vehicle	Stop	2	18 x 18	648
RT-2	MUTCD	Regulatory	Motor Vehicle	Yield	1	36 x 36	1296
RT-3P (MCO)	MUTCD	Regulatory	Motor Vehicle	Stop For Pedestrians in Crosswalks	4	12 x 36	1728
RT-4	MUTCD	Regulatory	Bicycle	Stop Sign Additional Sign	2	18 x 6	216
RT-6a	MUTCD	Regulatory	Motor Vehicle	No U Turn	1	24 x 24	400
RT-17	DOT	Regulatory	Motor Vehicle	Bike Lane	8	18 x 30	5400
RT-1 (L)	DOT	Regulatory	Motor Vehicle	No Parking Anywhere (Left Arrow)	4	18 x 18	648
RT-1 (R)	DOT	Regulatory	Motor Vehicle	No Parking Anywhere (Right Arrow)	3	18 x 18	486
RT-23a	DOT	Regulatory	Motor Vehicle	45 Degree Back-in Parking	1	12 x 12	144
RT-23a (L)	DOT	Regulatory	Motor Vehicle	45 Degree Back-in Parking (Left Arrow)	1	12 x 12	144
RT-23a (R)	DOT	Regulatory	Motor Vehicle	45 Degree Back-in Parking (Right Arrow)	1	12 x 12	144
RT-106a (L)	DOT	Regulatory	Motor Vehicle	Two Hour Parking (Left Arrow)	2	18 x 30	1080
RT-106a (R)	DOT	Regulatory	Motor Vehicle	Two Hour Parking (Right Arrow)	3	18 x 30	1620
RT-11-2	DOT	Warning	Motor Vehicle	Pedestrian Crossing	3	36 x 36	3888
RT-7a	DOT	Warning	Motor Vehicle	Left Arrow	3	24 x 24	1440
Total:							18,228

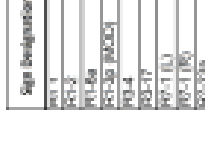
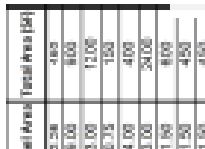

DATE	REVISION	BY

D.C. DEPARTMENT OF TRANSPORTATION
PLANNING AND SUSTAINABILITY DIVISION
ACTIVE TRANSPORTATION PROGRAM

TORRESQUE VILLAS
1600 15th St NW
Washington, DC 20005

PROJECT NOTES & PERMITS SUMMARY SHEET

NO.	DATE	BY	REVISION
1			

PAVEMENT MARKING QUANTITIES

ITEM	QUANTITY	UNIT
THERMOPLASTIC PAVEMENT MARKINGS - STRIPING		
4" WHITE THERMOPLASTIC PAVEMENT MARKING - SOLID	4623	LF
4" WHITE THERMOPLASTIC PAVEMENT MARKING - SOLID (ANGLED 45 DEG, NO PARKING ZONE)	1098	LF
6" WHITE THERMOPLASTIC PAVEMENT MARKING - DASHED (2" STRIPE, 4' SKIP)*	44	LF
4" YELLOW THERMOPLASTIC PAVEMENT MARKING - DOUBLE SOLID	950	LF
4" YELLOW THERMOPLASTIC PAVEMENT MARKING - SOLID	120	LF
6" YELLOW THERMOPLASTIC PAVEMENT MARKING - SOLID (F ANGLED 45 DEG, NO PARKING ZONE)	32	LF
6" WHITE THERMOPLASTIC PAVEMENT MARKING - SOLID	800	LF
6" WHITE THERMOPLASTIC PAVEMENT MARKING - DASHED (2" STRIPE, 4' SKIP)*	840	LF
12" WHITE THERMOPLASTIC PAVEMENT MARKING - SOLID (STOP BAR)	130	LF
24" WHITE THERMOPLASTIC PAVEMENT MARKING - SOLID (CROSSWALK MARKING)	820	LF
WHITE THERMOPLASTIC PAVEMENT MARKING - SYMBOLS		
BIKE LANE SYMBOL	34	EA
SHARDED LANE SYMBOL	21	EA
YIELD TRIANGLE SYMBOL	11	EA
SPEED HUMP CHEVRON	3	EA
COLORIZED PAVEMENT MARKINGS		
BIKE LANE GREEN PAVEMENT MARKINGS	240	SF
CYCLE TRACK BUFFER MATERIALS		
FLEXIBLE CHANNEL/LAGER POST	18	EA



S.C. DEPARTMENT OF TRANSPORTATION
PLANNING AND SUPPORT DIVISION
ACTIVE TRANSPORTATION PROGRAM

TENNESSEE AVENUE
BLOOMINGDALE CAMPUS, BT
SC 10, 8TH FL. NO.

PAVEMENT MARKING
QUANTITIES

NO.	DATE	BY	REVISION
1			

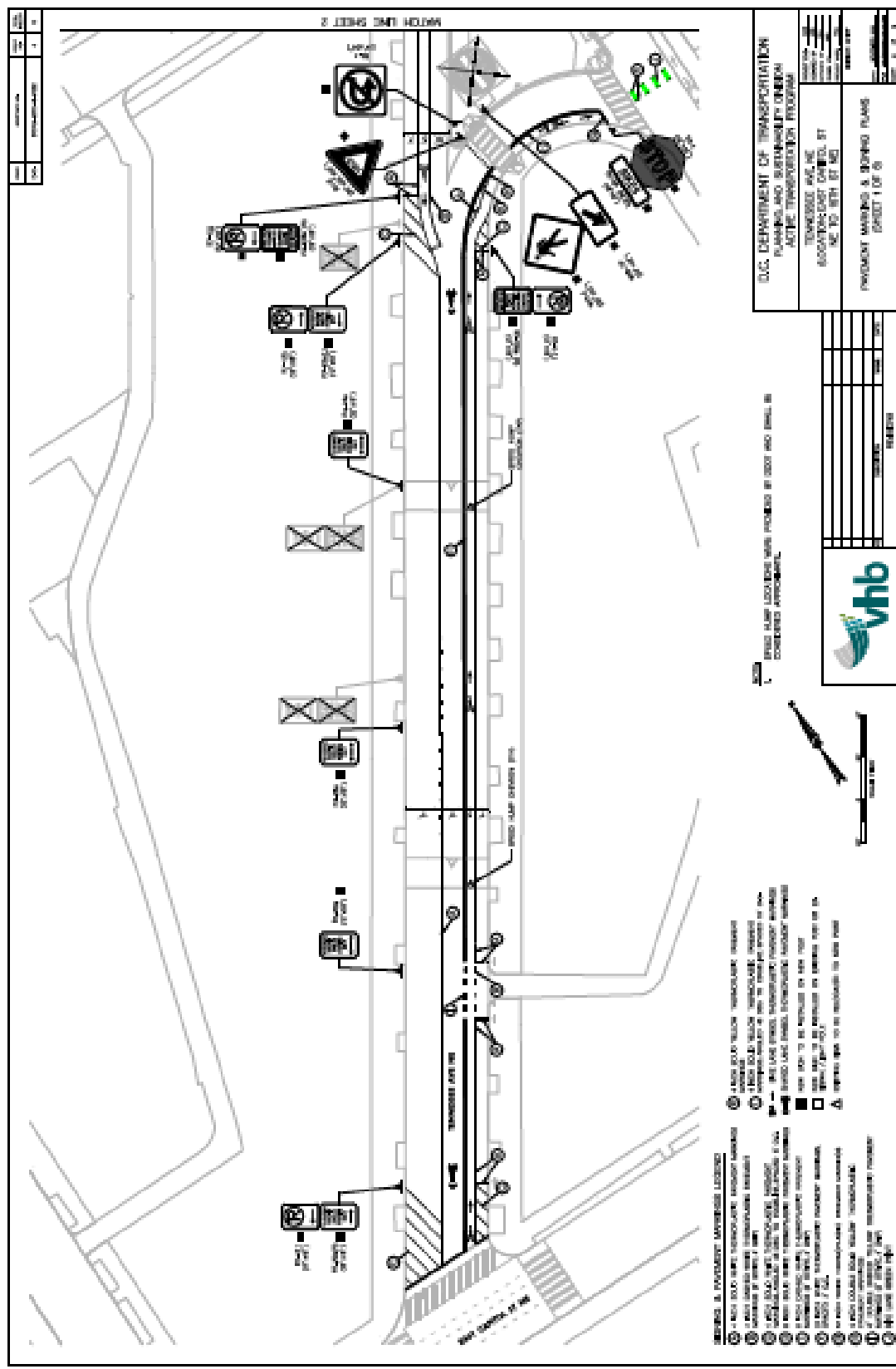

NO.	DESCRIPTION	DATE
1		
2		
3		

PROJECT SHEET 2

D.C. DEPARTMENT OF TRANSPORTATION
PLANNING AND SUBDIVISION DIVISION
ACTIVE TRANSPORTATION PROGRAM

TENNESSEE AVE NE
 ASSOCIATED-START CAPITAL BY
 MC TO 8TH ST NE

PROJECT MARKING & SIGNING PLANS
 SHEET 1 OF 2

NO.	REVISIONS	DATE	BY

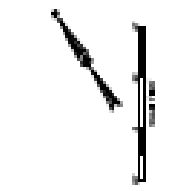

- REVISIONS & FOOTNOTES:**
- 1. ADD SIGNAGE FOR INTERSECTION OF TENNESSEE AVE NE AND 10TH ST NE
 - 2. ADD SIGNAGE FOR INTERSECTION OF TENNESSEE AVE NE AND 11TH ST NE
 - 3. ADD SIGNAGE FOR INTERSECTION OF TENNESSEE AVE NE AND 12TH ST NE
 - 4. ADD SIGNAGE FOR INTERSECTION OF TENNESSEE AVE NE AND 13TH ST NE
 - 5. ADD SIGNAGE FOR INTERSECTION OF TENNESSEE AVE NE AND 14TH ST NE
 - 6. ADD SIGNAGE FOR INTERSECTION OF TENNESSEE AVE NE AND 15TH ST NE
 - 7. ADD SIGNAGE FOR INTERSECTION OF TENNESSEE AVE NE AND 16TH ST NE
 - 8. ADD SIGNAGE FOR INTERSECTION OF TENNESSEE AVE NE AND 17TH ST NE
 - 9. ADD SIGNAGE FOR INTERSECTION OF TENNESSEE AVE NE AND 18TH ST NE
 - 10. ADD SIGNAGE FOR INTERSECTION OF TENNESSEE AVE NE AND 19TH ST NE
 - 11. ADD SIGNAGE FOR INTERSECTION OF TENNESSEE AVE NE AND 20TH ST NE
 - 12. ADD SIGNAGE FOR INTERSECTION OF TENNESSEE AVE NE AND 21ST ST NE
 - 13. ADD SIGNAGE FOR INTERSECTION OF TENNESSEE AVE NE AND 22ND ST NE
 - 14. ADD SIGNAGE FOR INTERSECTION OF TENNESSEE AVE NE AND 23RD ST NE
 - 15. ADD SIGNAGE FOR INTERSECTION OF TENNESSEE AVE NE AND 24TH ST NE
 - 16. ADD SIGNAGE FOR INTERSECTION OF TENNESSEE AVE NE AND 25TH ST NE
 - 17. ADD SIGNAGE FOR INTERSECTION OF TENNESSEE AVE NE AND 26TH ST NE
 - 18. ADD SIGNAGE FOR INTERSECTION OF TENNESSEE AVE NE AND 27TH ST NE
 - 19. ADD SIGNAGE FOR INTERSECTION OF TENNESSEE AVE NE AND 28TH ST NE
 - 20. ADD SIGNAGE FOR INTERSECTION OF TENNESSEE AVE NE AND 29TH ST NE
 - 21. ADD SIGNAGE FOR INTERSECTION OF TENNESSEE AVE NE AND 30TH ST NE
 - 22. ADD SIGNAGE FOR INTERSECTION OF TENNESSEE AVE NE AND 31ST ST NE
 - 23. ADD SIGNAGE FOR INTERSECTION OF TENNESSEE AVE NE AND 32ND ST NE
 - 24. ADD SIGNAGE FOR INTERSECTION OF TENNESSEE AVE NE AND 33RD ST NE
 - 25. ADD SIGNAGE FOR INTERSECTION OF TENNESSEE AVE NE AND 34TH ST NE
 - 26. ADD SIGNAGE FOR INTERSECTION OF TENNESSEE AVE NE AND 35TH ST NE
 - 27. ADD SIGNAGE FOR INTERSECTION OF TENNESSEE AVE NE AND 36TH ST NE
 - 28. ADD SIGNAGE FOR INTERSECTION OF TENNESSEE AVE NE AND 37TH ST NE
 - 29. ADD SIGNAGE FOR INTERSECTION OF TENNESSEE AVE NE AND 38TH ST NE
 - 30. ADD SIGNAGE FOR INTERSECTION OF TENNESSEE AVE NE AND 39TH ST NE
 - 31. ADD SIGNAGE FOR INTERSECTION OF TENNESSEE AVE NE AND 40TH ST NE
 - 32. ADD SIGNAGE FOR INTERSECTION OF TENNESSEE AVE NE AND 41ST ST NE
 - 33. ADD SIGNAGE FOR INTERSECTION OF TENNESSEE AVE NE AND 42ND ST NE
 - 34. ADD SIGNAGE FOR INTERSECTION OF TENNESSEE AVE NE AND 43RD ST NE
 - 35. ADD SIGNAGE FOR INTERSECTION OF TENNESSEE AVE NE AND 44TH ST NE
 - 36. ADD SIGNAGE FOR INTERSECTION OF TENNESSEE AVE NE AND 45TH ST NE
 - 37. ADD SIGNAGE FOR INTERSECTION OF TENNESSEE AVE NE AND 46TH ST NE
 - 38. ADD SIGNAGE FOR INTERSECTION OF TENNESSEE AVE NE AND 47TH ST NE
 - 39. ADD SIGNAGE FOR INTERSECTION OF TENNESSEE AVE NE AND 48TH ST NE
 - 40. ADD SIGNAGE FOR INTERSECTION OF TENNESSEE AVE NE AND 49TH ST NE
 - 41. ADD SIGNAGE FOR INTERSECTION OF TENNESSEE AVE NE AND 50TH ST NE

THIS PLAN LOCATIONS MARK PROPOSED BY DOTT AND SHALL BE CONSIDERED APPROVED.

NO.	DATE	DESCRIPTION
1	10/15/10	ISSUED FOR PERMIT
2	10/15/10	ISSUED FOR PERMIT

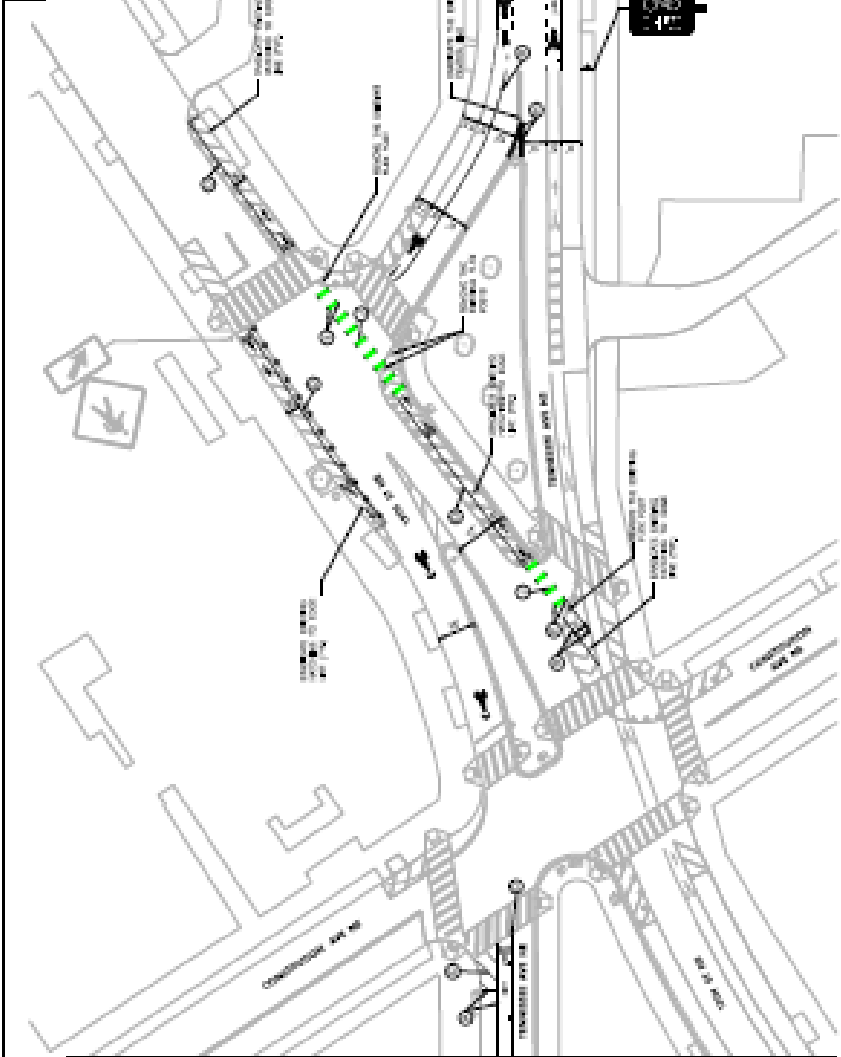

**U.S. DEPARTMENT OF TRANSPORTATION
PLANNING AND RESEARCH CENTER
ACTIVE TRANSPORTATION PROGRAM**

THE UNIVERSITY OF TENNESSEE
100 UNIVERSITY DRIVE
KNOXVILLE, TN 37996-0001

**PROJECT MARKING & SIGNING PLANS
SHEET 1 OF 2**

NO.	DATE	DESCRIPTION
1	10/15/10	ISSUED FOR PERMIT
2	10/15/10	ISSUED FOR PERMIT

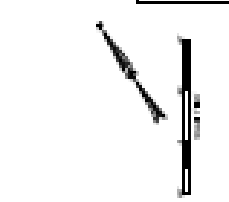

- LEGEND**
- ① - 12" x 18" SIGN (SEE "SIGNAGE" SHEETS)
 - ② - 18" x 24" SIGN (SEE "SIGNAGE" SHEETS)
 - ③ - 24" x 36" SIGN (SEE "SIGNAGE" SHEETS)
 - ④ - 36" x 48" SIGN (SEE "SIGNAGE" SHEETS)
 - ⑤ - 48" x 72" SIGN (SEE "SIGNAGE" SHEETS)
 - ⑥ - 72" x 96" SIGN (SEE "SIGNAGE" SHEETS)
 - ⑦ - 96" x 120" SIGN (SEE "SIGNAGE" SHEETS)
 - ⑧ - 120" x 144" SIGN (SEE "SIGNAGE" SHEETS)
 - ⑨ - 144" x 168" SIGN (SEE "SIGNAGE" SHEETS)
 - ⑩ - 168" x 192" SIGN (SEE "SIGNAGE" SHEETS)
 - ⑪ - 192" x 216" SIGN (SEE "SIGNAGE" SHEETS)
 - ⑫ - 216" x 240" SIGN (SEE "SIGNAGE" SHEETS)
 - ⑬ - 240" x 264" SIGN (SEE "SIGNAGE" SHEETS)
 - ⑭ - 264" x 288" SIGN (SEE "SIGNAGE" SHEETS)
 - ⑮ - 288" x 312" SIGN (SEE "SIGNAGE" SHEETS)
 - ⑯ - 312" x 336" SIGN (SEE "SIGNAGE" SHEETS)
 - ⑰ - 336" x 360" SIGN (SEE "SIGNAGE" SHEETS)
 - ⑱ - 360" x 384" SIGN (SEE "SIGNAGE" SHEETS)
 - ⑲ - 384" x 408" SIGN (SEE "SIGNAGE" SHEETS)
 - ⑳ - 408" x 432" SIGN (SEE "SIGNAGE" SHEETS)
 - ㉑ - 432" x 456" SIGN (SEE "SIGNAGE" SHEETS)
 - ㉒ - 456" x 480" SIGN (SEE "SIGNAGE" SHEETS)
 - ㉓ - 480" x 504" SIGN (SEE "SIGNAGE" SHEETS)
 - ㉔ - 504" x 528" SIGN (SEE "SIGNAGE" SHEETS)
 - ㉕ - 528" x 552" SIGN (SEE "SIGNAGE" SHEETS)
 - ㉖ - 552" x 576" SIGN (SEE "SIGNAGE" SHEETS)
 - ㉗ - 576" x 600" SIGN (SEE "SIGNAGE" SHEETS)
 - ㉘ - 600" x 624" SIGN (SEE "SIGNAGE" SHEETS)
 - ㉙ - 624" x 648" SIGN (SEE "SIGNAGE" SHEETS)
 - ㉚ - 648" x 672" SIGN (SEE "SIGNAGE" SHEETS)
 - ㉛ - 672" x 696" SIGN (SEE "SIGNAGE" SHEETS)
 - ㉜ - 696" x 720" SIGN (SEE "SIGNAGE" SHEETS)
 - ㉝ - 720" x 744" SIGN (SEE "SIGNAGE" SHEETS)
 - ㉞ - 744" x 768" SIGN (SEE "SIGNAGE" SHEETS)
 - ㉟ - 768" x 792" SIGN (SEE "SIGNAGE" SHEETS)
 - ㊱ - 792" x 816" SIGN (SEE "SIGNAGE" SHEETS)
 - ㊲ - 816" x 840" SIGN (SEE "SIGNAGE" SHEETS)
 - ㊳ - 840" x 864" SIGN (SEE "SIGNAGE" SHEETS)
 - ㊴ - 864" x 888" SIGN (SEE "SIGNAGE" SHEETS)
 - ㊵ - 888" x 912" SIGN (SEE "SIGNAGE" SHEETS)
 - ㊶ - 912" x 936" SIGN (SEE "SIGNAGE" SHEETS)
 - ㊷ - 936" x 960" SIGN (SEE "SIGNAGE" SHEETS)
 - ㊸ - 960" x 984" SIGN (SEE "SIGNAGE" SHEETS)
 - ㊹ - 984" x 1008" SIGN (SEE "SIGNAGE" SHEETS)
 - ㊺ - 1008" x 1032" SIGN (SEE "SIGNAGE" SHEETS)
 - ㊻ - 1032" x 1056" SIGN (SEE "SIGNAGE" SHEETS)
 - ㊼ - 1056" x 1080" SIGN (SEE "SIGNAGE" SHEETS)
 - ㊽ - 1080" x 1104" SIGN (SEE "SIGNAGE" SHEETS)
 - ㊾ - 1104" x 1128" SIGN (SEE "SIGNAGE" SHEETS)
 - ㊿ - 1128" x 1152" SIGN (SEE "SIGNAGE" SHEETS)

- LEGEND (CONTINUED)**
- ① - 12" x 18" SIGN (SEE "SIGNAGE" SHEETS)
 - ② - 18" x 24" SIGN (SEE "SIGNAGE" SHEETS)
 - ③ - 24" x 36" SIGN (SEE "SIGNAGE" SHEETS)
 - ④ - 36" x 48" SIGN (SEE "SIGNAGE" SHEETS)
 - ⑤ - 48" x 72" SIGN (SEE "SIGNAGE" SHEETS)
 - ⑥ - 72" x 96" SIGN (SEE "SIGNAGE" SHEETS)
 - ⑦ - 96" x 120" SIGN (SEE "SIGNAGE" SHEETS)
 - ⑧ - 120" x 144" SIGN (SEE "SIGNAGE" SHEETS)
 - ⑨ - 144" x 168" SIGN (SEE "SIGNAGE" SHEETS)
 - ⑩ - 168" x 192" SIGN (SEE "SIGNAGE" SHEETS)
 - ⑪ - 192" x 216" SIGN (SEE "SIGNAGE" SHEETS)
 - ⑫ - 216" x 240" SIGN (SEE "SIGNAGE" SHEETS)
 - ⑬ - 240" x 264" SIGN (SEE "SIGNAGE" SHEETS)
 - ⑭ - 264" x 288" SIGN (SEE "SIGNAGE" SHEETS)
 - ⑮ - 288" x 312" SIGN (SEE "SIGNAGE" SHEETS)
 - ⑯ - 312" x 336" SIGN (SEE "SIGNAGE" SHEETS)
 - ⑰ - 336" x 360" SIGN (SEE "SIGNAGE" SHEETS)
 - ⑱ - 360" x 384" SIGN (SEE "SIGNAGE" SHEETS)
 - ⑲ - 384" x 408" SIGN (SEE "SIGNAGE" SHEETS)
 - ⑳ - 408" x 432" SIGN (SEE "SIGNAGE" SHEETS)
 - ㉑ - 432" x 456" SIGN (SEE "SIGNAGE" SHEETS)
 - ㉒ - 456" x 480" SIGN (SEE "SIGNAGE" SHEETS)
 - ㉓ - 480" x 504" SIGN (SEE "SIGNAGE" SHEETS)
 - ㉔ - 504" x 528" SIGN (SEE "SIGNAGE" SHEETS)
 - ㉕ - 528" x 552" SIGN (SEE "SIGNAGE" SHEETS)
 - ㉖ - 552" x 576" SIGN (SEE "SIGNAGE" SHEETS)
 - ㉗ - 576" x 600" SIGN (SEE "SIGNAGE" SHEETS)
 - ㉘ - 600" x 624" SIGN (SEE "SIGNAGE" SHEETS)
 - ㉙ - 624" x 648" SIGN (SEE "SIGNAGE" SHEETS)
 - ㉚ - 648" x 672" SIGN (SEE "SIGNAGE" SHEETS)
 - ㉛ - 672" x 696" SIGN (SEE "SIGNAGE" SHEETS)
 - ㉜ - 696" x 720" SIGN (SEE "SIGNAGE" SHEETS)
 - ㉝ - 720" x 744" SIGN (SEE "SIGNAGE" SHEETS)
 - ㉞ - 744" x 768" SIGN (SEE "SIGNAGE" SHEETS)
 - ㉟ - 768" x 792" SIGN (SEE "SIGNAGE" SHEETS)
 - ㊱ - 792" x 816" SIGN (SEE "SIGNAGE" SHEETS)
 - ㊲ - 816" x 840" SIGN (SEE "SIGNAGE" SHEETS)
 - ㊳ - 840" x 864" SIGN (SEE "SIGNAGE" SHEETS)
 - ㊴ - 864" x 888" SIGN (SEE "SIGNAGE" SHEETS)
 - ㊵ - 888" x 912" SIGN (SEE "SIGNAGE" SHEETS)
 - ㊶ - 912" x 936" SIGN (SEE "SIGNAGE" SHEETS)
 - ㊷ - 936" x 960" SIGN (SEE "SIGNAGE" SHEETS)
 - ㊸ - 960" x 984" SIGN (SEE "SIGNAGE" SHEETS)
 - ㊹ - 984" x 1008" SIGN (SEE "SIGNAGE" SHEETS)
 - ㊺ - 1008" x 1032" SIGN (SEE "SIGNAGE" SHEETS)
 - ㊻ - 1032" x 1056" SIGN (SEE "SIGNAGE" SHEETS)
 - ㊼ - 1056" x 1080" SIGN (SEE "SIGNAGE" SHEETS)
 - ㊽ - 1080" x 1104" SIGN (SEE "SIGNAGE" SHEETS)
 - ㊾ - 1104" x 1128" SIGN (SEE "SIGNAGE" SHEETS)
 - ㊿ - 1128" x 1152" SIGN (SEE "SIGNAGE" SHEETS)

MATCH LINE SHEET 1

MATCH LINE SHEET 2

DATE	DESCRIPTION

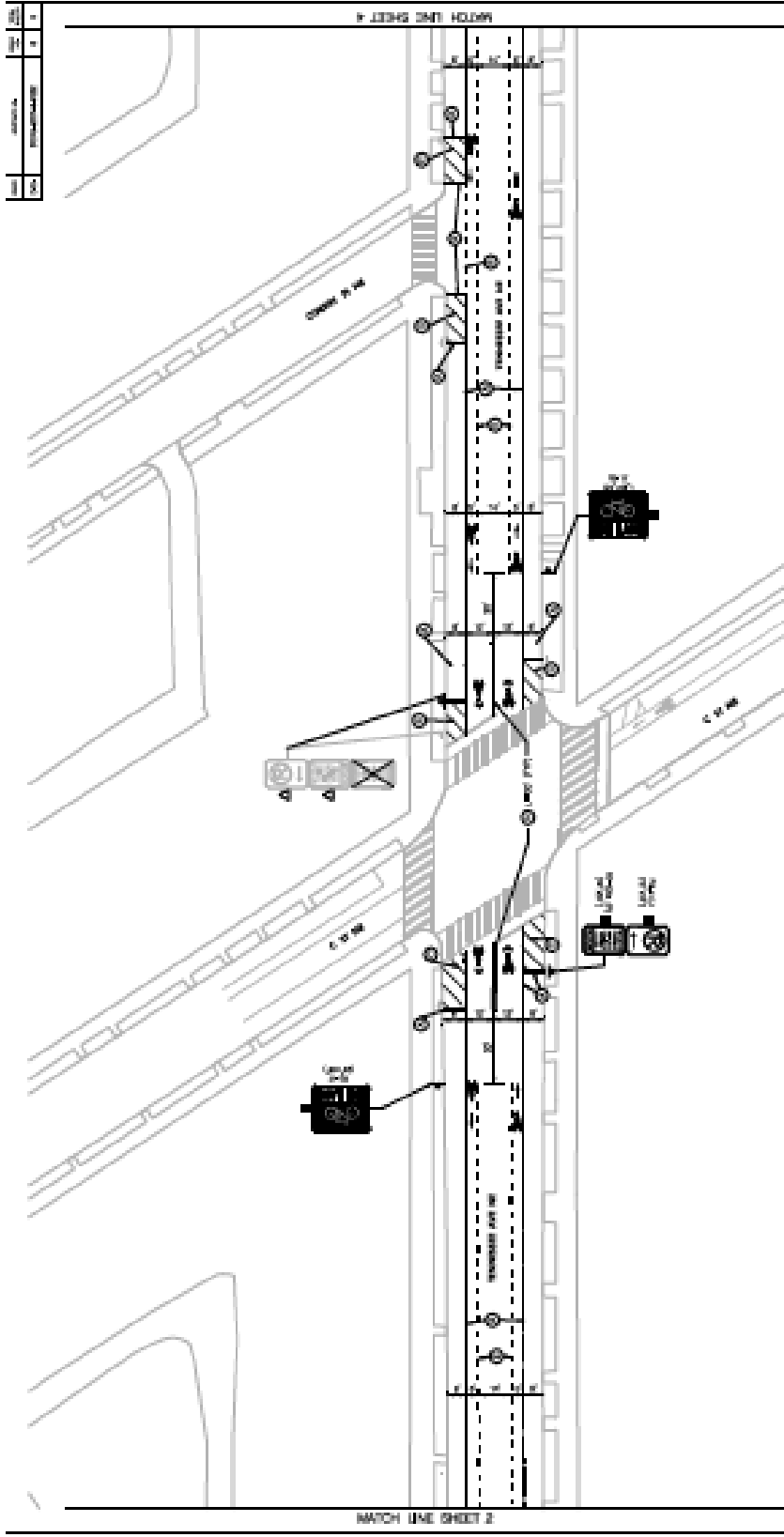

- LEGEND**
- ① - 1500 VOLT TRANSFORMER (SEE SHEET 2)
 - ② - TRANSFORMER ROOM
 - ③ - TRANSFORMER ROOM
 - ④ - TRANSFORMER ROOM
 - ⑤ - TRANSFORMER ROOM
 - ⑥ - TRANSFORMER ROOM
 - ⑦ - TRANSFORMER ROOM
 - ⑧ - TRANSFORMER ROOM
 - ⑨ - TRANSFORMER ROOM
 - ⑩ - TRANSFORMER ROOM
 - ⑪ - TRANSFORMER ROOM
 - ⑫ - TRANSFORMER ROOM
 - ⑬ - TRANSFORMER ROOM
 - ⑭ - TRANSFORMER ROOM
 - ⑮ - TRANSFORMER ROOM
 - ⑯ - TRANSFORMER ROOM
 - ⑰ - TRANSFORMER ROOM
 - ⑱ - TRANSFORMER ROOM
 - ⑲ - TRANSFORMER ROOM
 - ⑳ - TRANSFORMER ROOM
 - ㉑ - TRANSFORMER ROOM
 - ㉒ - TRANSFORMER ROOM
 - ㉓ - TRANSFORMER ROOM
 - ㉔ - TRANSFORMER ROOM
 - ㉕ - TRANSFORMER ROOM
 - ㉖ - TRANSFORMER ROOM
 - ㉗ - TRANSFORMER ROOM
 - ㉘ - TRANSFORMER ROOM
 - ㉙ - TRANSFORMER ROOM
 - ㉚ - TRANSFORMER ROOM
 - ㉛ - TRANSFORMER ROOM
 - ㉜ - TRANSFORMER ROOM
 - ㉝ - TRANSFORMER ROOM
 - ㉞ - TRANSFORMER ROOM
 - ㉟ - TRANSFORMER ROOM
 - Ⓐ - TRANSFORMER ROOM
 - Ⓑ - TRANSFORMER ROOM
 - Ⓒ - TRANSFORMER ROOM
 - Ⓓ - TRANSFORMER ROOM
 - Ⓔ - TRANSFORMER ROOM
 - Ⓕ - TRANSFORMER ROOM
 - Ⓖ - TRANSFORMER ROOM
 - Ⓗ - TRANSFORMER ROOM
 - Ⓘ - TRANSFORMER ROOM
 - Ⓚ - TRANSFORMER ROOM
 - Ⓛ - TRANSFORMER ROOM
 - Ⓜ - TRANSFORMER ROOM
 - Ⓨ - TRANSFORMER ROOM
 - Ⓩ - TRANSFORMER ROOM
 - ⓑ - TRANSFORMER ROOM
 - ⓓ - TRANSFORMER ROOM
 - ⓔ - TRANSFORMER ROOM
 - ⓖ - TRANSFORMER ROOM
 - ⓗ - TRANSFORMER ROOM
 - ⓘ - TRANSFORMER ROOM
 - ⓙ - TRANSFORMER ROOM
 - ⓛ - TRANSFORMER ROOM
 - ⓜ - TRANSFORMER ROOM
 - ⓞ - TRANSFORMER ROOM
 - ⓟ - TRANSFORMER ROOM
 - ⓠ - TRANSFORMER ROOM
 - ⓡ - TRANSFORMER ROOM
 - ⓢ - TRANSFORMER ROOM
 - ⓤ - TRANSFORMER ROOM
 - ⓦ - TRANSFORMER ROOM
 - ⓧ - TRANSFORMER ROOM
 - ⓨ - TRANSFORMER ROOM
 - ⓩ - TRANSFORMER ROOM
 - ⓫ - TRANSFORMER ROOM
 - ⓬ - TRANSFORMER ROOM
 - ⓭ - TRANSFORMER ROOM
 - ⓮ - TRANSFORMER ROOM
 - ⓯ - TRANSFORMER ROOM
 - ⓰ - TRANSFORMER ROOM
 - ⓱ - TRANSFORMER ROOM
 - ⓲ - TRANSFORMER ROOM
 - ⓳ - TRANSFORMER ROOM
 - ⓴ - TRANSFORMER ROOM
 - ⓵ - TRANSFORMER ROOM
 - ⓶ - TRANSFORMER ROOM
 - ⓷ - TRANSFORMER ROOM
 - ⓸ - TRANSFORMER ROOM
 - ⓹ - TRANSFORMER ROOM
 - ⓺ - TRANSFORMER ROOM
 - ⓻ - TRANSFORMER ROOM
 - ⓼ - TRANSFORMER ROOM
 - ⓽ - TRANSFORMER ROOM
 - ⓿ - TRANSFORMER ROOM



D.C. DEPARTMENT OF TRANSPORTATION
 PLANNING AND SUBSTANTIATION DIVISION
 ACTIVE TRANSPORTATION PROGRAM

TRANSFORMER AND AIR
 6000 PENNSYLVANIA AVENUE, ST
 NE, WASHINGTON, DC 20011-0001

PROJECT NAME: S. BOWEN BLVD
 SHEET 1 OF 6

NO.	DESCRIPTION	DATE
1		
2		
3		
4		
5		
6		
7		
8		
9		
10		



NO.	REVISION	DATE

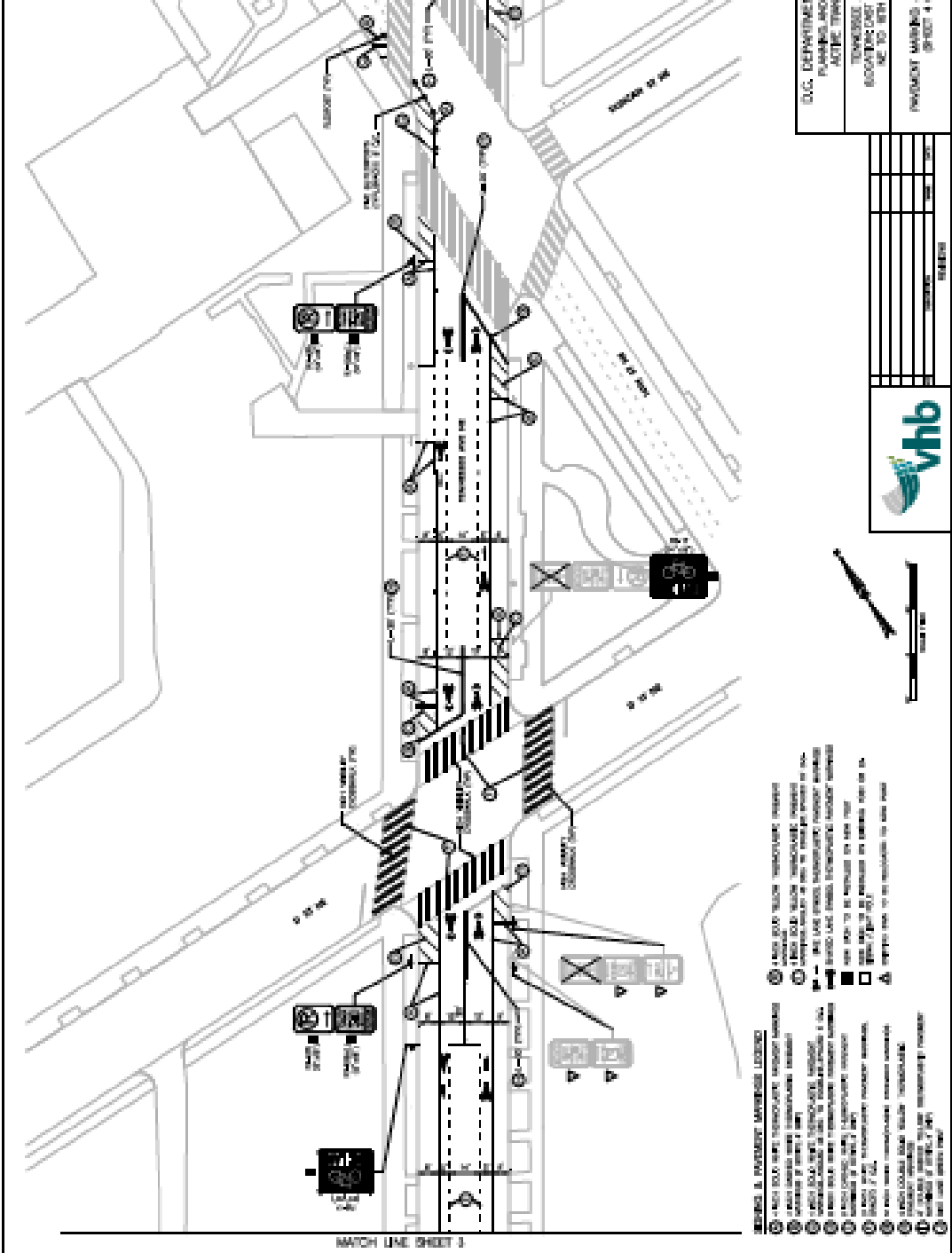

- LEGEND - UTILITY MARKING SYMBOLS**
- 1. 6" GAS (UNL) TYPED
 - 2. 12" GAS (UNL) TYPED
 - 3. 18" GAS (UNL) TYPED
 - 4. 24" GAS (UNL) TYPED
 - 5. 36" GAS (UNL) TYPED
 - 6. 48" GAS (UNL) TYPED
 - 7. 60" GAS (UNL) TYPED
 - 8. 72" GAS (UNL) TYPED
 - 9. 84" GAS (UNL) TYPED
 - 10. 96" GAS (UNL) TYPED
 - 11. 108" GAS (UNL) TYPED
 - 12. 120" GAS (UNL) TYPED
 - 13. 132" GAS (UNL) TYPED
 - 14. 144" GAS (UNL) TYPED
 - 15. 156" GAS (UNL) TYPED
 - 16. 168" GAS (UNL) TYPED
 - 17. 180" GAS (UNL) TYPED
 - 18. 192" GAS (UNL) TYPED
 - 19. 204" GAS (UNL) TYPED
 - 20. 216" GAS (UNL) TYPED
 - 21. 228" GAS (UNL) TYPED
 - 22. 240" GAS (UNL) TYPED
 - 23. 252" GAS (UNL) TYPED
 - 24. 264" GAS (UNL) TYPED
 - 25. 276" GAS (UNL) TYPED
 - 26. 288" GAS (UNL) TYPED
 - 27. 300" GAS (UNL) TYPED

- LEGEND - UTILITY MARKING SYMBOLS**
- 1. 6" WATER (UNL) TYPED
 - 2. 12" WATER (UNL) TYPED
 - 3. 18" WATER (UNL) TYPED
 - 4. 24" WATER (UNL) TYPED
 - 5. 36" WATER (UNL) TYPED
 - 6. 48" WATER (UNL) TYPED
 - 7. 60" WATER (UNL) TYPED
 - 8. 72" WATER (UNL) TYPED
 - 9. 84" WATER (UNL) TYPED
 - 10. 96" WATER (UNL) TYPED
 - 11. 108" WATER (UNL) TYPED
 - 12. 120" WATER (UNL) TYPED
 - 13. 132" WATER (UNL) TYPED
 - 14. 144" WATER (UNL) TYPED
 - 15. 156" WATER (UNL) TYPED
 - 16. 168" WATER (UNL) TYPED
 - 17. 180" WATER (UNL) TYPED
 - 18. 192" WATER (UNL) TYPED
 - 19. 204" WATER (UNL) TYPED
 - 20. 216" WATER (UNL) TYPED
 - 21. 228" WATER (UNL) TYPED
 - 22. 240" WATER (UNL) TYPED
 - 23. 252" WATER (UNL) TYPED
 - 24. 264" WATER (UNL) TYPED
 - 25. 276" WATER (UNL) TYPED
 - 26. 288" WATER (UNL) TYPED
 - 27. 300" WATER (UNL) TYPED

- 1. 6" SEWER (UNL) TYPED
- 2. 12" SEWER (UNL) TYPED
- 3. 18" SEWER (UNL) TYPED
- 4. 24" SEWER (UNL) TYPED
- 5. 36" SEWER (UNL) TYPED
- 6. 48" SEWER (UNL) TYPED
- 7. 60" SEWER (UNL) TYPED
- 8. 72" SEWER (UNL) TYPED
- 9. 84" SEWER (UNL) TYPED
- 10. 96" SEWER (UNL) TYPED
- 11. 108" SEWER (UNL) TYPED
- 12. 120" SEWER (UNL) TYPED
- 13. 132" SEWER (UNL) TYPED
- 14. 144" SEWER (UNL) TYPED
- 15. 156" SEWER (UNL) TYPED
- 16. 168" SEWER (UNL) TYPED
- 17. 180" SEWER (UNL) TYPED
- 18. 192" SEWER (UNL) TYPED
- 19. 204" SEWER (UNL) TYPED
- 20. 216" SEWER (UNL) TYPED
- 21. 228" SEWER (UNL) TYPED
- 22. 240" SEWER (UNL) TYPED
- 23. 252" SEWER (UNL) TYPED
- 24. 264" SEWER (UNL) TYPED
- 25. 276" SEWER (UNL) TYPED
- 26. 288" SEWER (UNL) TYPED
- 27. 300" SEWER (UNL) TYPED

S.C. DEPARTMENT OF TRANSPORTATION
 PLANNING AND SURVEILLANCE CENTER
 ACTIVE TRANSPORTATION PROGRAM
 COLUMBIA, SOUTH CAROLINA
 29201

PROJECT MARKING & BORING PLANS
 SHEET 4 OF 9

REVISIONS	
NO.	DESCRIPTION

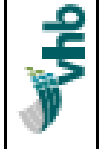

NO.	REVISION	DATE
1	ISSUED FOR CONSTRUCTION	11/11/11

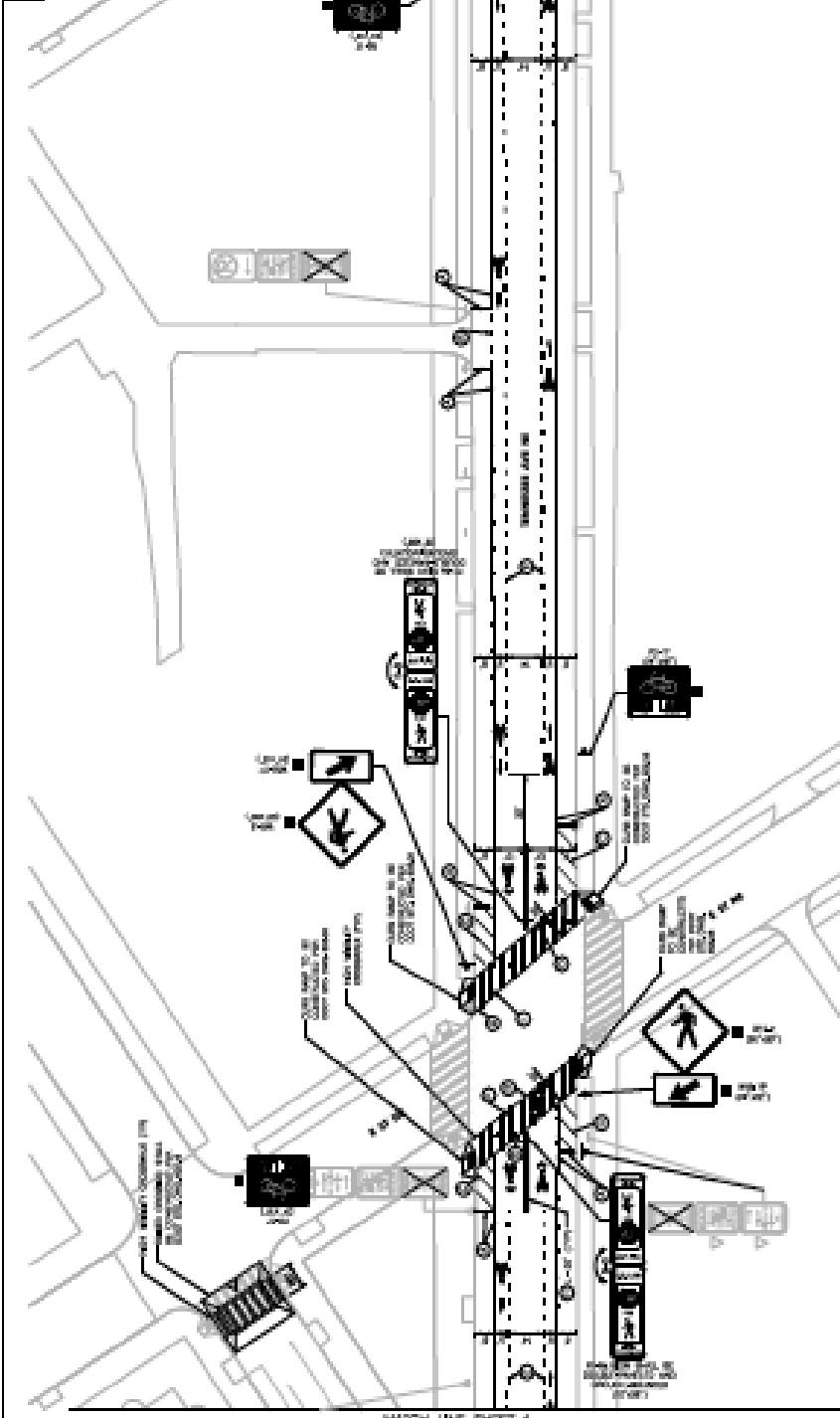

MATCH LINE SHEET 4

MATCH LINE SHEET 6

- REMARKS & PAVEMENT MARKINGS LEGEND**
- ① - 4" x 6" x 0.5" WHITE THERMOPLASTIC TAHOOT MARKING
 - ② - 4" x 6" x 0.5" WHITE THERMOPLASTIC TAHOOT MARKING
 - ③ - 4" x 6" x 0.5" WHITE THERMOPLASTIC TAHOOT MARKING
 - ④ - 4" x 6" x 0.5" WHITE THERMOPLASTIC TAHOOT MARKING
 - ⑤ - 4" x 6" x 0.5" WHITE THERMOPLASTIC TAHOOT MARKING
 - ⑥ - 4" x 6" x 0.5" WHITE THERMOPLASTIC TAHOOT MARKING
 - ⑦ - 4" x 6" x 0.5" WHITE THERMOPLASTIC TAHOOT MARKING
 - ⑧ - 4" x 6" x 0.5" WHITE THERMOPLASTIC TAHOOT MARKING
 - ⑨ - 4" x 6" x 0.5" WHITE THERMOPLASTIC TAHOOT MARKING
 - ⑩ - 4" x 6" x 0.5" WHITE THERMOPLASTIC TAHOOT MARKING
 - ⑪ - 4" x 6" x 0.5" WHITE THERMOPLASTIC TAHOOT MARKING
 - ⑫ - 4" x 6" x 0.5" WHITE THERMOPLASTIC TAHOOT MARKING
 - ⑬ - 4" x 6" x 0.5" WHITE THERMOPLASTIC TAHOOT MARKING
 - ⑭ - 4" x 6" x 0.5" WHITE THERMOPLASTIC TAHOOT MARKING
 - ⑮ - 4" x 6" x 0.5" WHITE THERMOPLASTIC TAHOOT MARKING
 - ⑯ - 4" x 6" x 0.5" WHITE THERMOPLASTIC TAHOOT MARKING
 - ⑰ - 4" x 6" x 0.5" WHITE THERMOPLASTIC TAHOOT MARKING
 - ⑱ - 4" x 6" x 0.5" WHITE THERMOPLASTIC TAHOOT MARKING
 - ⑲ - 4" x 6" x 0.5" WHITE THERMOPLASTIC TAHOOT MARKING
 - ⑳ - 4" x 6" x 0.5" WHITE THERMOPLASTIC TAHOOT MARKING
 - ㉑ - 4" x 6" x 0.5" WHITE THERMOPLASTIC TAHOOT MARKING
 - ㉒ - 4" x 6" x 0.5" WHITE THERMOPLASTIC TAHOOT MARKING
 - ㉓ - 4" x 6" x 0.5" WHITE THERMOPLASTIC TAHOOT MARKING
 - ㉔ - 4" x 6" x 0.5" WHITE THERMOPLASTIC TAHOOT MARKING
 - ㉕ - 4" x 6" x 0.5" WHITE THERMOPLASTIC TAHOOT MARKING
 - ㉖ - 4" x 6" x 0.5" WHITE THERMOPLASTIC TAHOOT MARKING
 - ㉗ - 4" x 6" x 0.5" WHITE THERMOPLASTIC TAHOOT MARKING
 - ㉘ - 4" x 6" x 0.5" WHITE THERMOPLASTIC TAHOOT MARKING
 - ㉙ - 4" x 6" x 0.5" WHITE THERMOPLASTIC TAHOOT MARKING
 - ㉚ - 4" x 6" x 0.5" WHITE THERMOPLASTIC TAHOOT MARKING
 - ㉛ - 4" x 6" x 0.5" WHITE THERMOPLASTIC TAHOOT MARKING
 - ㉜ - 4" x 6" x 0.5" WHITE THERMOPLASTIC TAHOOT MARKING
 - ㉝ - 4" x 6" x 0.5" WHITE THERMOPLASTIC TAHOOT MARKING
 - ㉞ - 4" x 6" x 0.5" WHITE THERMOPLASTIC TAHOOT MARKING
 - ㉟ - 4" x 6" x 0.5" WHITE THERMOPLASTIC TAHOOT MARKING
 - ㊱ - 4" x 6" x 0.5" WHITE THERMOPLASTIC TAHOOT MARKING
 - ㊲ - 4" x 6" x 0.5" WHITE THERMOPLASTIC TAHOOT MARKING
 - ㊳ - 4" x 6" x 0.5" WHITE THERMOPLASTIC TAHOOT MARKING
 - ㊴ - 4" x 6" x 0.5" WHITE THERMOPLASTIC TAHOOT MARKING
 - ㊵ - 4" x 6" x 0.5" WHITE THERMOPLASTIC TAHOOT MARKING
 - ㊶ - 4" x 6" x 0.5" WHITE THERMOPLASTIC TAHOOT MARKING
 - ㊷ - 4" x 6" x 0.5" WHITE THERMOPLASTIC TAHOOT MARKING
 - ㊸ - 4" x 6" x 0.5" WHITE THERMOPLASTIC TAHOOT MARKING
 - ㊹ - 4" x 6" x 0.5" WHITE THERMOPLASTIC TAHOOT MARKING
 - ㊺ - 4" x 6" x 0.5" WHITE THERMOPLASTIC TAHOOT MARKING
 - ㊻ - 4" x 6" x 0.5" WHITE THERMOPLASTIC TAHOOT MARKING
 - ㊼ - 4" x 6" x 0.5" WHITE THERMOPLASTIC TAHOOT MARKING
 - ㊽ - 4" x 6" x 0.5" WHITE THERMOPLASTIC TAHOOT MARKING
 - ㊾ - 4" x 6" x 0.5" WHITE THERMOPLASTIC TAHOOT MARKING
 - ㊿ - 4" x 6" x 0.5" WHITE THERMOPLASTIC TAHOOT MARKING

**D.C. DEPARTMENT OF TRANSPORTATION
PLANNING AND REVENUE DIVISION
ACTIVE TRANSPORTATION PROGRAM**

TENNESSEE AVE. NE
SECTION 0401 (PART OF)
DC TO 10TH ST NE

PROJECT MARKING & SIGNING PLANS
(SHEET 5 OF 6)

NO.	REVISION	DATE
1	ISSUED FOR CONSTRUCTION	11/11/11



DATE	DESCRIPTION	BY
04/15/2014	ISSUE FOR PERMITS	JK

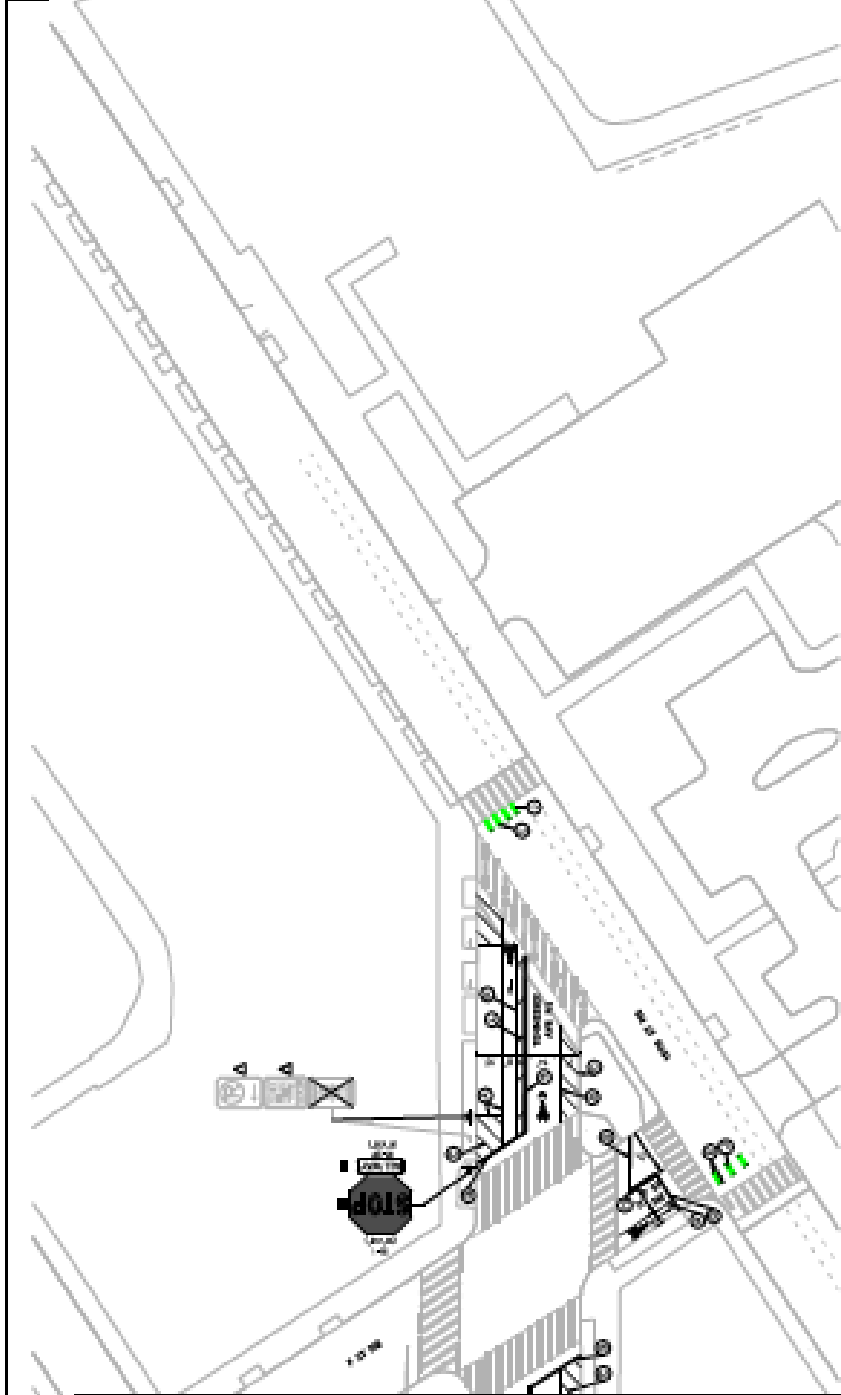

MATCH LINE SHEET 5

- REVISIONS & PAYMENT MARKINGS LEGEND:**
- ① - NEW ROAD MARK, TEMPORARILY INDICATED MARKING
 - ② - NEW ROAD MARK, TEMPORARILY INDICATED MARKING
 - ③ - NEW ROAD MARK, TEMPORARILY INDICATED MARKING
 - ④ - NEW ROAD MARK, TEMPORARILY INDICATED MARKING
 - ⑤ - NEW ROAD MARK, TEMPORARILY INDICATED MARKING
 - ⑥ - NEW ROAD MARK, TEMPORARILY INDICATED MARKING
 - ⑦ - NEW ROAD MARK, TEMPORARILY INDICATED MARKING
 - ⑧ - NEW ROAD MARK, TEMPORARILY INDICATED MARKING
 - ⑨ - NEW ROAD MARK, TEMPORARILY INDICATED MARKING
 - ⑩ - NEW ROAD MARK, TEMPORARILY INDICATED MARKING
 - ⑪ - NEW ROAD MARK, TEMPORARILY INDICATED MARKING
 - ⑫ - NEW ROAD MARK, TEMPORARILY INDICATED MARKING
 - ⑬ - NEW ROAD MARK, TEMPORARILY INDICATED MARKING
 - ⑭ - NEW ROAD MARK, TEMPORARILY INDICATED MARKING
 - ⑮ - NEW ROAD MARK, TEMPORARILY INDICATED MARKING
 - ⑯ - NEW ROAD MARK, TEMPORARILY INDICATED MARKING
 - ⑰ - NEW ROAD MARK, TEMPORARILY INDICATED MARKING
 - ⑱ - NEW ROAD MARK, TEMPORARILY INDICATED MARKING
 - ⑲ - NEW ROAD MARK, TEMPORARILY INDICATED MARKING
 - ⑳ - NEW ROAD MARK, TEMPORARILY INDICATED MARKING
 - ㉑ - NEW ROAD MARK, TEMPORARILY INDICATED MARKING
 - ㉒ - NEW ROAD MARK, TEMPORARILY INDICATED MARKING
 - ㉓ - NEW ROAD MARK, TEMPORARILY INDICATED MARKING
 - ㉔ - NEW ROAD MARK, TEMPORARILY INDICATED MARKING
 - ㉕ - NEW ROAD MARK, TEMPORARILY INDICATED MARKING
 - ㉖ - NEW ROAD MARK, TEMPORARILY INDICATED MARKING
 - ㉗ - NEW ROAD MARK, TEMPORARILY INDICATED MARKING
 - ㉘ - NEW ROAD MARK, TEMPORARILY INDICATED MARKING
 - ㉙ - NEW ROAD MARK, TEMPORARILY INDICATED MARKING
 - ㉚ - NEW ROAD MARK, TEMPORARILY INDICATED MARKING
 - ㉛ - NEW ROAD MARK, TEMPORARILY INDICATED MARKING
 - ㉜ - NEW ROAD MARK, TEMPORARILY INDICATED MARKING
 - ㉝ - NEW ROAD MARK, TEMPORARILY INDICATED MARKING
 - ㉞ - NEW ROAD MARK, TEMPORARILY INDICATED MARKING
 - ㉟ - NEW ROAD MARK, TEMPORARILY INDICATED MARKING
 - ㊱ - NEW ROAD MARK, TEMPORARILY INDICATED MARKING
 - ㊲ - NEW ROAD MARK, TEMPORARILY INDICATED MARKING
 - ㊳ - NEW ROAD MARK, TEMPORARILY INDICATED MARKING
 - ㊴ - NEW ROAD MARK, TEMPORARILY INDICATED MARKING
 - ㊵ - NEW ROAD MARK, TEMPORARILY INDICATED MARKING
 - ㊶ - NEW ROAD MARK, TEMPORARILY INDICATED MARKING
 - ㊷ - NEW ROAD MARK, TEMPORARILY INDICATED MARKING
 - ㊸ - NEW ROAD MARK, TEMPORARILY INDICATED MARKING
 - ㊹ - NEW ROAD MARK, TEMPORARILY INDICATED MARKING
 - ㊺ - NEW ROAD MARK, TEMPORARILY INDICATED MARKING
 - ㊻ - NEW ROAD MARK, TEMPORARILY INDICATED MARKING
 - ㊼ - NEW ROAD MARK, TEMPORARILY INDICATED MARKING
 - ㊽ - NEW ROAD MARK, TEMPORARILY INDICATED MARKING
 - ㊾ - NEW ROAD MARK, TEMPORARILY INDICATED MARKING
 - ㊿ - NEW ROAD MARK, TEMPORARILY INDICATED MARKING

U.S. DEPARTMENT OF TRANSPORTATION
FEDERAL AID TO HIGHWAY PROGRAMS
ACTIVE TRANSPORTATION PROGRAM

TECHNICAL SPECIFICATIONS
 SECTION 200 - PAVEMENT MARKINGS
 PART 200.01 - PAVEMENT MARKINGS

PROJECT MARKING & SIGNING PLAN
 SHEET 5 OF 6

NO.	DATE	REVISION
1	04/15/2014	ISSUE FOR PERMITS
2		
3		
4		
5		
6		
7		
8		
9		
10		





District of Columbia
Transportation Online Permitting System
 Internal Site for Permit Office and Reviewing Agencies



[Home](#) [Notice of Violation](#) [Stop Work Order](#) [Reviews](#) [Report](#) [Others](#) [Recent Plots](#) [Sign out](#)

Welcome SMD 6A08
 You are logged in as Agency Reviewer, Single Members District

OCCUPANCY PERMIT P

[Back To Search Results](#)

Application Summary					
Tracking #: 10854279	Application Creation Date: 4/19/2021 10:35:51 AM	Company Name: INDIVIDUAL	Company Code: INDIVIDUAL		
Assigned Tech: Kisha Allen	Last Update Date: 4/29/2021 9:41:59 AM	Last Updated By: Kisha Allen	Permit #:		
Assigned Inspector: Malik Hyilton	Inspection Status: Not Inspected	Work Zone Deposit Status: N/A	Contract #/Construction Permit:		
Review Status: PENDING	Review Due Date: 05/19/2021	Locked: X	Renewal: X		
Status: Assigned View History	Applicant Info: Jeremiah Cohen 5540 Nevada Ave, NW, Washington, DC 20015 Day Phone: 2024942609 Cell Phone: 2024942609 Email Address: jeremiah.coh@gmail.com	Permittee Info: Jeremiah Cohen 5540 Nevada Ave NW, Washington, DC 20015 Business Phone: 2024942609 Email Address: jeremiah.coh@gmail.com	Owner Info: Jeremiah Cohen 5540 Nevada Ave NW, Washington, DC 20015 Business Phone: 2024942609 Email Address: jeremiah.coh@gmail.com		
Permit Renewal History and Amendments: No records to display					

DCRA License/Permit Information	
Important Note: TOPS has not matched License holder's name and business address against current permit application. Also, the license was obtained in the past, please see the Date Information Obtained below. License status "Active", "Ready to Batch Print" and "Ready to Renew" are Eligible for this permit application.	
DCRA License Number: 931319000125	License Type: Restaurant
License Status: Ready to Renew	Expiration Date: 3/31/2021
License Holder Name: COLORADO & COHEN LLC.	Date Information Obtained: 04/21/2021 03:20 PM
Address: 1341 H ST NE	

Event Detail					
Event Type: New Sidewalk Cafe Un-Enclosed	Start Date: 05/07/2021	Start Time:	End Date:	End Time:	Issue Date: N/A
Location: 1341 H STREET NE	SSL: 1027	Description: sidewalk in front of Bullfrog Bagels.... only use portion of sidewalk up to the seam of sidewalk which is about 4 feet from our building facade and would include two bistro metal bistro tables and 4 metal bistro chairs. This is only for a 14 foot section of sidewalk in front of 1341 H Street NE.	Main Ward: 6		
View other applications for this location					
EWR #:					

Address Summary	
View Location Info	View Map
Conflict With Other Application: Yes View other 1 confliction applications @ confliction EWR.	

Sidewalk Cafe Detail	
* Business Information	
Cafe Type: New Sidewalk Cafe Un-Enclosed	
Business Name: Bullfrog Bagels on H Street NE	
* Months of Cafe Operation	

Selected Month: January February March April May June July August September October November December

* Hours of Cafe Operation (Set 1)

Selected Days And Hours: Monday Tuesday Wednesday Thursday Friday Saturday Sunday : (7:00 AM - 1:00 AM)

Hours of Cafe Operation (Set 2)

Selected Days And Hours: N/A

* Furniture

Total No. of Tables: 2 Total No. of ADA Tables: 2 Table Sizes: 23.6" dia x 28" tall Total No. of Seats: 4

* Awnings/Umbrellas

Has Coverings? No No. of Umbrellas: N/A Umbrella clearance when open (ft): N/A Clearance of Awning (ft): N/A

* Border

Has Fence or Wall? No Fence Height (ft): N/A Number of Gates: N/A Width of Gate Opening (ft): N/A Type of Fence: N/A Planter Height (ft) (including Plants Planted): N/A

* Dimensions

Width of Cafe (ft): 14 Depth of Cafe (ft): 4
Total Square Footage (SF): 56 Width of Aisle (ft): 2

Dimensions

Street 1: H STREET			
Number of car spaces			
Type of Lane (22ft/space)	Length(ft)	Width(ft)	

Restrictions

Rush Hour: No Fire Hydrant: No Bus Stop: No Drop Off/ Lay By: No Drive Way: No
Loading Zone: No Snow Route: No Street Cleaning: No Metro Entrance: No Utility Access (e.g. Manhole): No
Capital Bike Share: No Car Sharing Parking: No Furniture/Fixtures: No Zipcar: No

Will "Washington Metropolitan Area Transit Authority" relocate? No

Equipments

No Equipment selected.

Deposit Refund Information

Name: Address: Phone: Tax ID: Email:
Deposit Amount: Deposit on file: No

Parking Meter Information

Location has meter(s).

Number Of Meters: 0 Invoice Id: 0 Total Meter Fee: \$0.00 Meter Paid: No

Parking Meter Bagging / Removal Information

No Meter Bagging and Removal Details to display for this application

Document Information

[Download All Files as Zip](#)

<input type="checkbox"/>	Document Type	View	Status	Document Name	Size(kb)	Uploaded By	Date Uploaded	Public Access?	For PSC?
<input type="checkbox"/>	Certificate of Occupancy	<input type="checkbox"/>	Submitted Online	Cohen_CO.pdf	637	Jeremiah Cohen	4/20/2021 8:18:11 AM	N	N
<input type="checkbox"/>	Fixture/Furniture Drawings	<input type="checkbox"/>	Submitted Online	fixrespecs.pdf	502	Jeremiah Cohen	4/20/2021 8:42:52 AM	N	N
<input type="checkbox"/>	Insurance for Sidewalk Cafe	<input type="checkbox"/>	Submitted Online	Certificate.pdf	99	Jeremiah Cohen	4/23/2021 8:07:54 AM	N	N

<input type="checkbox"/>	Document Type	View	Status	Document Name	Size(kb)	Uploaded By	Date Uploaded	Public Access?	For PSC?
<input type="checkbox"/>	Lease Agreement	<input type="checkbox"/>	Submitted Online	document1341242webE.pdf	8,277	Jeremiah Cohen	4/20/2021 8:17:50 AM	N	N
<input type="checkbox"/>	Photos	<input type="checkbox"/>	Submitted Online	IMG_1300.jpg	3,768	Jeremiah Cohen	4/20/2021 8:18:31 AM	N	N
<input type="checkbox"/>	Photos	<input type="checkbox"/>	Submitted Online	IMG_1299.jpg	4,002	Jeremiah Cohen	4/20/2021 8:18:31 AM	N	N
<input type="checkbox"/>	Photos	<input type="checkbox"/>	Submitted Online	IMG_1298.jpg	3,538	Jeremiah Cohen	4/20/2021 8:18:31 AM	N	N
<input type="checkbox"/>	Photos	<input type="checkbox"/>	Submitted Online	IMG_1297.jpg	3,757	Jeremiah Cohen	4/20/2021 8:18:31 AM	N	N
<input type="checkbox"/>	Photos	<input type="checkbox"/>	Submitted Online	IMG_1296.jpg	3,600	Jeremiah Cohen	4/20/2021 8:18:32 AM	N	N
<input type="checkbox"/>	Public Space Committee Plans - Sidewalk Cafe	<input type="checkbox"/>	Submitted Online	PublicSpaceRulesandInnovationCafe.pdf	39	Jeremiah Cohen	4/23/2021 8:43:43 AM	N	N
<input type="checkbox"/>	Scaled Plans	<input type="checkbox"/>	Submitted Online	unenclosedaterialsidewalk.pdf	521	Jeremiah Cohen	4/23/2021 8:15:39 AM	N	N

[Mark Selected Documents For PSC](#) [Remove Selected Documents For PSC](#)

Reviewing Agency **▼** **SHOW**

[View Reviewer's Previous Notes](#) [Review Activity Log](#)

Internal Notes

No notes to display for this application

Notes For Applicant

No notes to display for this application

Event Questions & Answers

No Question and Answer to display for this application

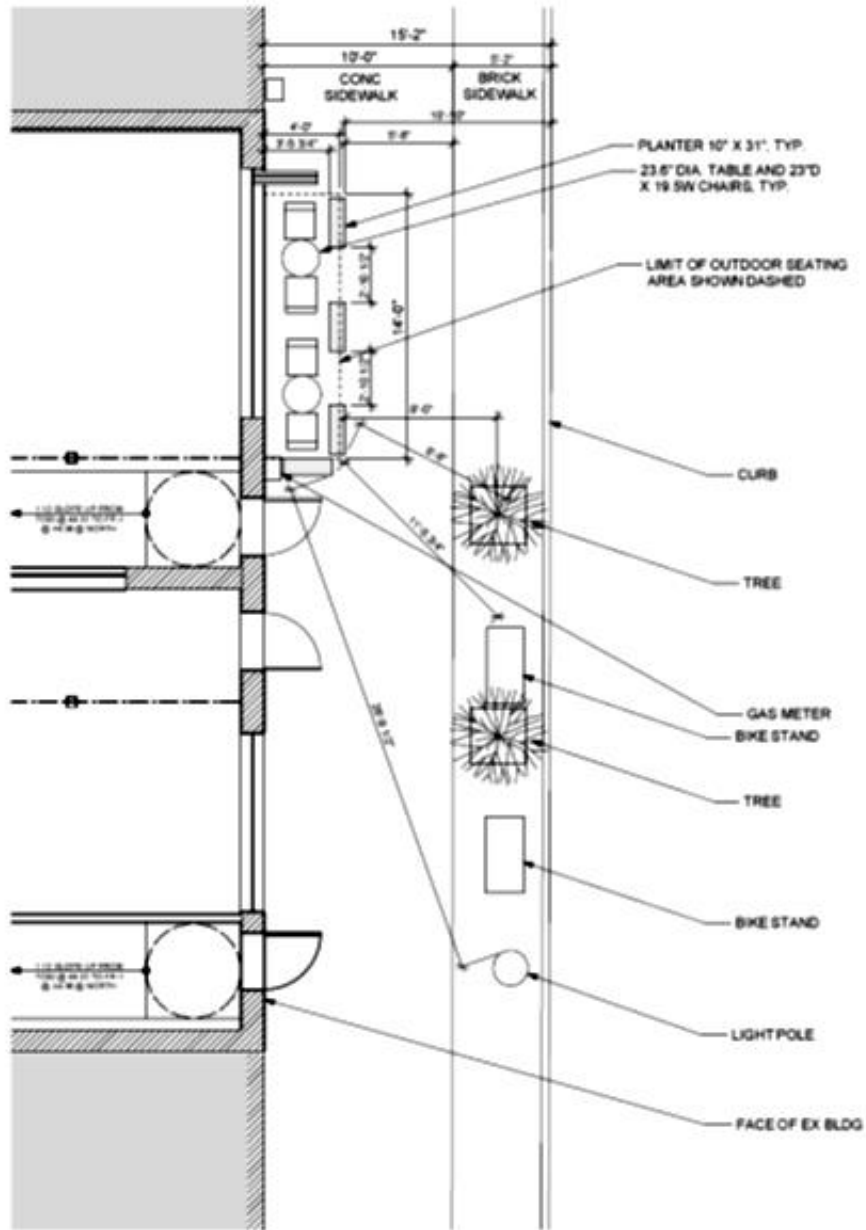

1 SIDEWALK
 A2.0.1 Scale: 3/16" = 1'-0"

UNFINISHED DESIGN BY INTERIOR PARTS ARCHITECTURE

THIS DOCUMENT IS PRELIMINARY AND NOT FOR CONSTRUCTION. IT IS THE PROPERTY OF INTERIOR PARTS ARCHITECTURE AND IS NOT TO BE REPRODUCED, COPIED, OR TRANSMITTED IN ANY FORM OR BY ANY MEANS, ELECTRONIC OR MECHANICAL, INCLUDING PHOTOCOPYING, RECORDING, OR BY ANY INFORMATION STORAGE AND RETRIEVAL SYSTEM. WITHOUT THE WRITTEN PERMISSION OF INTERIOR PARTS ARCHITECTURE.

IF THE REQUIREMENT OF ANY LOCAL AGENCY OR OTHER PARTY HAS BEEN MET BY THIS DOCUMENT, THE ARCHITECT ASSUMES NO LIABILITY FOR ANY DAMAGE, LOSS, OR INJURY TO PERSONS OR PROPERTY, OR FOR ANY COSTS OF LITIGATION, ARISING FROM THE USE OF THIS DOCUMENT FOR ANY PURPOSE OTHER THAN THAT FOR WHICH IT WAS PREPARED. THE ARCHITECT ASSUMES NO LIABILITY FOR ANY DAMAGE, LOSS, OR INJURY TO PERSONS OR PROPERTY, OR FOR ANY COSTS OF LITIGATION, ARISING FROM THE USE OF THIS DOCUMENT FOR ANY PURPOSE OTHER THAN THAT FOR WHICH IT WAS PREPARED.

		Interior Parts Architecture 1041 H STREET NE, WASHINGTON DC 20002 P 202 462 9888 F 202 462 4888 www.interiorpartsarchitecture.com	SEARCHLIGHTS BUILDING 1361 H STREET N.E. WASHINGTON, D.C. 20002	A210
		Building Footcandle Calculation Scheduling	A210	A210

Reviewing Agencies Notes for the Tracking No: 10854279

PSI

Assigned Reviewer: Malik Hylton

Status: APPROVED

Notes:

May 5 2021 1:54PM mhylton wrote for Applicant - MUST BE IN COMPLIANCE WITH ALL REGULATIONS GOVERNING SIDEWALK CAFES IN THE DISTRICT OF COLUMBIA. ANY PART OF CAFE THAT IS PARALLEL TO THE TREE SPACE MUST STILL MAINTAIN SIX FEET MINIMUM OF SIDEWALK CLEARANCE. IF LOCATED AT STREET INTERSECTIONS, CAFE'S MUST PROVIDE CLEARANCE OF 10' TO THE CORNER. NO SIDEWALK CAFE SHALL BE SHALL BE WITHIN 15' OF A BUS STOP, BUS SHELTER, OR METRORAIL STATION ENTRANCE.Permanent fixtures cannot be placed in areas where public utility access covers exist. All fixtures such as, umbrellas, heaters, etc; must be on a approved seating plan to exist in the cafe area, and the approved plan must be on site at all times.

PEPCO

Assigned Reviewer: Parker Wright

Status: PENDING

Notes:

DC Water

Assigned Reviewer: David Paige

Status: PENDING

Notes:

FEMS/Const

Assigned Reviewer: John Barnes

Status: REVISION NEEDED

Notes:

Apr 29 2021 8:11PM sharris wrote for Applicant - A DRIFT OF WHERE THE TABLE AND CHAIRS ARE NEEDED AND THE SPACING BETWEEN THEM (SOMETHING NOT HAND DRAWN IS PREFERRED)

DOH

Assigned Reviewer: Bruce Flippens

Status: NOT SENT

Notes:

IPMA

Assigned Reviewer: Edwin Edokwe

Status: NOT SENT

Notes:

ANC

Assigned Reviewer: ANC 6A

Status: PENDING

Notes:**TOA**

Assigned Reviewer: Leon Anderson

Status: NOT SENT

Notes:**WMATA/JDAC**

Assigned Reviewer: LaShawn Bost

Status: PENDING

Notes:**VERIZON**

Assigned Reviewer: Mary Polk

Status: APPROVED

Notes:**OTR**

Assigned Reviewer: Gregory Glover

Status: NOT SENT

Notes:**ADA/CIVIL RIGHT**

Assigned Reviewer: Levon Petrosian

Status: NOT SENT

Notes:**OP-Urban Design**

Assigned Reviewer: Rita Abou Samra

Status: REVISION NEEDED

Notes:

May 10 2021 3:45PM rabousamra wrote for Applicant - PLEASE SUBMIT A SCALED PUBLIC SPACE PLAN SHOWING THE ACCURATE LOCATION OF THE PROPERTY LINE AND ALL ELEMENTS IN PUBLIC SPACE BETWEEN THE PROPERTY LINE AND THE CURB. SHOW ALL SIDEWALK CAFÉ ELEMENTS (TABLES, CHAIRS, AND 3' AISLES BETWEEN CHAIRS AT ADJACENT TABLES) AND THE CAFÉ'S PLANTER BORDER; AND ADD PLANTERS AND PLANTER HEIGHT TO THE APPLICATION WORK DETAIL UNDER "BORDER". ON THE PLAN, SHOW THAT THE OUTER EXTENT OF THE SIDEWALK CAFÉ (OUTER EDGE OF THE PLANTERS IN THIS CASE) IS AT LEAST 8' FROM THE NEAREST OBSTACLE IN PUBLIC SPACE, AS REQUIRED FOR MODERATE DENSITY MIXED-USE AREAS. ALSO, SUBMIT AN ELEVATION OF THE CAFÉ OR USE THE PLANTER SKETCH UPLOADED IN THE SPEC SHEET TO SHOW THAT THE PLANTER HEIGHT INCLUDING THE PLANTING WITHIN DOES NOT EXCEED 36". CLARIFY IF THE TABLES AND CHAIRS SHOWN IN THE SITE PICTURES ARE THE SAME ONES THAT WILL BE USED IN THE PROPOSED PLAN. FINALLY, ON THE SITE PLAN, SHOW HOW PEOPLE WITH DISABILITIES CAN ACCESS THE SIDEWALK CAFÉ SPACE AND ADA SEATING, SINCE THE SLIDING DOORS DO NOT SEEM TO BE AT-LEVEL WITH THE SIDEWALK.

UFA

Assigned Reviewer: Sharon Dendy

Status: PENDING

Notes:**WASH GAS**

Assigned Reviewer: Don Srisukwattananan

Status: PENDING

Notes:**DCRA FIRE**

Assigned Reviewer: Luchi Lu

Status: NOT SENT

Notes:**Single Members District**

Assigned Reviewer: SMD 6A06

Status: PENDING

Notes:**CashManager**

Assigned Reviewer: Tiffany Tenbrook

Status: NOT SENT

Notes:**PSRD Planning**

Assigned Reviewer: Evelyn Israel

Status: REVISION NEEDED

Notes:

May 10 2021 3:56PM eisraelPSRDPLN wrote for Applicant - WHILE YOUR UPLOADS NOTE 12' FROM THE CAFE TO THE CURB, THAT UNFORTUNATELY IS NOT HOW CLEAR PEDESTRIAN SIDEWALK SPACE IS MEASURED (AS NOTED IN YOUR UPLOAD). INSTEAD, IT IS MEASURED TO THE NEAREST OBSTRUCTION COMING OUT FROM THE CURB (TYPICALLY THE EDGE OF A TREE BOX). EVEN IF NO TREE BOX EXISTS IN FRONT OF YOUR SITE, WHICH DOES NOT APPEAR TO BE THE CASE BASED ON GOOGLE IMAGES, IT IS STILL MEASURED FROM THAT TREE BOX EDGE LINE EXTENDED AS THE CLEAR SPACE IS NOT INTENDED TO ZIG ZAG BUT BE A STRAIGHT LINE DOWN AN ENTIRE BLOCK. A MINIMUM OF 8' CLEAR SPACE HAS BEEN PERMITTED ALONG H STREET FOR OTHER CAFE. PLEASE PROVIDE SCALED PLANS SHOWING ALL ELEMENTS IN PUBLIC SPACE (OR THE LINE EXTENDED OF THE STREET TREE ZONE), AND INCLUDE MEASUREMENTS, SUCH AS THE 8' CLEAR SPACE.

